



## FACTS AND INFORMATION

SHANGRI-LA HOTEL, TANGSHAN

## LOCATION

Shangri-La Hotel, Tangshan is located in Phoenix New Town at the north side of the city, and is adjacent to the new financial and commercial district of Tangshan.

The hotel is a 30-minute drive from the Tangshan Sannvhe Airport and 10-minute drive to Tangshan Train Station, where an extensive railway connection links Tangshan to many other key cities in mainland China.

## ACCOMMODATION

The hotel offers 301 elegant guestrooms, including 19 suites ranging in size from 45 to 135 square metres.

In addition, 34 well-appointed service apartments, ranging from a studio to a one- and two-bedroom unit, will be available.

For guests seeking a higher level of comfort and privacy, the well-appointed Horizon Club Lounge on the top floor is an exclusive retreat with picturesque park views.

## GUESTROOMS

| Categories      | Rooms | Area (m <sup>2</sup> ) |
|-----------------|-------|------------------------|
| Deluxe Room     | 228   | 45                     |
| Horizon Room    | 54    | 45                     |
| Executive Suite | 17    | 90                     |
| Specialty Suite | 2     | 135                    |

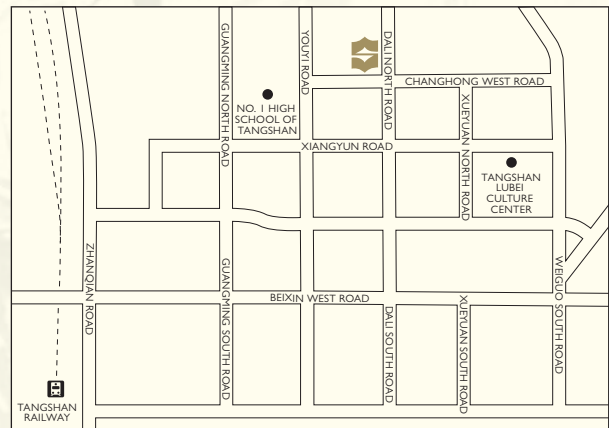

## GUESTROOM FEATURES

- Complimentary Wi-Fi and wireless Internet access
- Cable television channels
- Electronic in-room safe deposit box
- Bedside lighting controls
- Exclusive Shangri-La toiletries
- Executive writing desk
- Mini-bar
- Hair dryer
- International Direct Dial (IDD) telephone
- Voicemail
- Iron and ironing board
- Tea and coffee-making facilities
- Separate shower and bathtub
- Feather duvet and pillows
- Pillow menu with hypoallergenic options (only available for Horizon Club rooms and Suites)

## HORIZON CLUB PRIVILEGES

- Private check-in and check-out
- Late check-out at 4pm on day of departure
- Complimentary daily breakfast at the Horizon Club Lounge
- Complimentary beverages and snacks served all day
- Evening cocktails and savouries from 5pm to 7pm daily
- Wi-Fi and broadband Internet access
- Selection of newspapers and magazines
- Concierge and secretarial services
- One complimentary pressing (suit or dress) upon arrival
- Complimentary shoe-shine service
- Use of Horizon Club Lounge meeting room for two hours daily (advance booking required)

## RECREATION FACILITIES

- Fully-equipped gymnasium and health club
- Indoor temperature-controlled swimming pool
- Jacuzzi, sauna and steam room

## OTHER SERVICES AND FACILITIES

- 24-hour in-room dining
- Airport transfer
- Facilities for the physically challenged
- Safe deposit boxes
- Non-smoking rooms
- Courier, parcel and postal services
- Faxing and photocopying services
- Laundry and valet services
- Taxi and limousine services
- Babysitting and childcare
- City tour arrangement
- Air and train ticket services
- IT butlers
- Parking facilities
- Foreign currency exchange
- Service apartments

## RESTAURANTS AND BARS

| Restaurants / Bars | Capacity | Location | Cuisine                         |
|--------------------|----------|----------|---------------------------------|
| Tang Huang Ge      | 246      | Level 1  | Cantonese and local specialties |
| Café Shang         | 220      | Level 1  | International                   |
| Lobby Lounge       | 102      | Level 1  | Light snacks and beverages      |

## BANQUET AND CONFERENCE ROOMS

| Venue                     | Capacity  |         |         |           | Dimensions<br>(m) | Area<br>(m <sup>2</sup> ) | Ceiling Height<br>(m) |
|---------------------------|-----------|---------|---------|-----------|-------------------|---------------------------|-----------------------|
|                           | Reception | Theatre | Banquet | Classroom |                   |                           |                       |
| <b>Level 2</b>            |           |         |         |           |                   |                           |                       |
| Shangri-La Ballroom       | 1,400     | 1,600   | 1,000   | 1,000     | 32.8 x 54.9       | 1,800                     | 8.5                   |
| Ballroom A                | 450       | 500     | 320     | 320       | 32.8 x 17.5       | 574                       | 8.5                   |
| Ballroom B                | 460       | 520     | 330     | 330       | 32.8 x 18.1       | 594                       | 8.5                   |
| Ballroom C                | 450       | 500     | 320     | 320       | 32.8 x 17.5       | 574                       | 8.5                   |
| Shangri-La Ballroom Foyer | 300       | •       | •       | •         | 10.4 x 54.9       | 571                       | 6.5                   |
| Bridal Room               | •         | •       | •       | •         | 8.5 x 3.5         | 30                        | 3.2                   |
| Function Room 1           | 70        | 80      | 50      | 50        | 13.3 x 8.5        | 113                       | 3.4                   |
| Function Room 2           | 100       | 110     | 60      | 60        | 17.4 x 8.5        | 148                       | 3.4                   |
| Function Room 2A          | 50        | 50      | 30      | 30        | 8.7 x 8.5         | 74                        | 3.4                   |
| Function Room 2B          | 50        | 50      | 30      | 30        | 8.7 x 8.5         | 74                        | 3.4                   |
| Function Room 3           | 100       | 110     | 60      | 60        | 17.4 x 8.5        | 148                       | 3.4                   |
| Function Room 3A          | 50        | 50      | 30      | 30        | 8.7 x 8.5         | 74                        | 3.4                   |
| Function Room 3B          | 50        | 50      | 30      | 30        | 8.7 x 8.5         | 74                        | 3.4                   |
| Function Room 4           | 50        | 50      | 30      | 30        | 8.6 x 8.5         | 73                        | 3.4                   |
| Tangshan Room             | 80        | 90      | 60      | 60        | 16.6 x 8.6        | 143                       | 3.4                   |

LEVEL 2

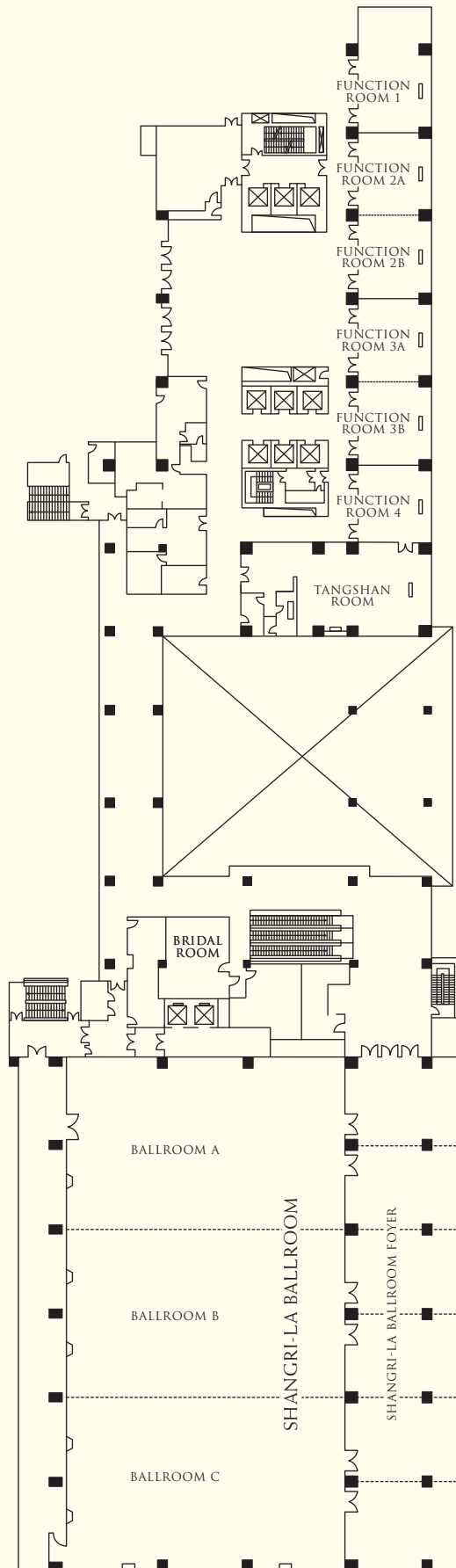



SHANGRI-LA

HOTELS *and* RESORTS

Shangri-La Hotel, Tangshan

889, Changhong West Road, Lubei District, Tangshan, Hebei 063000, China

Tel: (86 315) 539 8888 Fax: (86 315) 592 7888 [slts@shangri-la.com](mailto:slts@shangri-la.com) [www.shangri-la.com](http://www.shangri-la.com)