



FACTS AND INFORMATION

FUTIAN SHANGRI-LA, SHENZHEN

LOCATION

Futian Shangri-La, Shenzhen is located in the Futian District, the city's administration, cultural, exhibition and commerce centre. The hotel is just a short walk from Shenzhen's mass transit railway system - a very convenient way to travel around Shenzhen and to Hong Kong, via Futian Port. Shenzhen International Bao'an Airport is just 30 minutes away, Hong Kong International Airport is 60 minutes away, and Shekou Ferry Terminal to Hong Kong, Macau and Zhuhai is 25 minutes away by car. The Shenzhen Convention and Exhibition Centre and Shenzhen Civic Centre are within a kilometre of the hotel. What's more, the largest underground railway station in Asia – Futian High Speed Railway Station is adjacent to the hotel.



ACCOMMODATION

The hotel comprises of 478 guestrooms and 50 suites, which include three Specialty Suites, one Shangri-La Suite and one Presidential Suite with an impressive 288 square metres of space. 53 elegantly appointed serviced apartments are also available in one, two and three bedroom configurations, as well as one and two bedroom apartments with a study.

GUESTROOMS

Categories	Rooms	Area (m ²)
Deluxe Room	265	45
Deluxe City View Room	100	45
Premier Room	39	60
Executive Suite	40	96
Horizon Room	64	48
Horizon Premier Room	10	60
Deluxe Suite	5	144
Specialty Suite	3	192
Shangri-La Suite	1	240
Presidential Suite	1	288

GUESTROOM FEATURES

- Broadband and wireless Internet access
- IDD telephone with data port and voice mail
- Desk jack panel
- 24-hour in-room dining
- Electronic safe
- Satellite / cable television and movie channels
- Wall-mounted plasma television
- LCD television in the bathroom
- CD / DVD and MP3 unit (Horizon Club rooms and all suites)

HORIZON CLUB PRIVILEGES

- Personalised check-in and check-out
- Private Horizon Club Lounge
- Breakfast and evening cocktails
- Butler service
- One suit pressing per stay and shoeshine service
- Choice of international newspapers
- Private meeting rooms
- Selection of fresh fruit on arrival

MEET US CENTRE

“Meet Us” Centre bridges the hotel’s dedicated event management team and our valued guests and event organizers. At this connection point, our event experts offer one-stop service with professional advice and practical assistance in all aspects of event management, to ensure all events are hassle free from the very beginning to the end. Here, our Service Associates also offer secretarial support such as photocopying, conference call set up, business card printing, binding service and many more.

RECREATION FACILITIES

- CHI, The Spa at Shangri-La
- Health club
- Outdoor tennis courts
- Indoor swimming pool

OTHER SERVICES AND FACILITIES

- Non-smoking rooms
- Wheelchair-accessible rooms
- IT butlers
- Foreign currency exchange
- Courier, parcel and postal services
- Safe deposit boxes
- Limousine and taxi services
- Hair salon
- Manicure
- Laundry and valet service
- Parking facilities
- Car washing and detailing service

RESTAURANTS AND BARS

Restaurants / Bars	Capacity	Location	Cuisine
Lobby Lounge	138	Level 1	Beverages and snacks
Café Zen	228	Level 1	International
Shang Garden	138	Level 1	Huaiyang and Cantonese
Seventh Son	164	Level 2	Cantonese and regional Chinese
Shang Garden Bar	50	Level 1	Cocktails and snacks
Shang Gourmet	32	Level 1	Bakery, savory and drinks

BANQUET AND CONFERENCE ROOMS

Venue	Reception	Capacity			Classroom	Dimensions (m)	Area (m ²)	Ceiling Height (m)
		Theatre	Banquet					
Level 2								
Grand Ballroom	2,100	2,000	1,200	1,100	27.8 x 62.6	1,740	9.5	
Grand Ballroom 1	660	648	360	351	27.8 x 21.4	595	9.5	
Grand Ballroom 2	660	648	360	351	27.8 x 20.8	578	9.5	
Grand Ballroom 3	660	648	360	351	27.8 x 20.4	567	9.5	
Grand Ballroom 1&2	1,320	1,296	720	700	27.8 x 42.2	1,174	9.5	
Grand Ballroom 2&3	1,320	1,296	720	700	27.8 x 41.2	1,146	9.5	
Pre-Function Area	•	•	•	•	11.7 x 51.5	603	5.5	
VIP Room	18	•	•	•	18.4 x 9.5	151	4.2	
Bridal Room	10	•	•	•	16.0 x 7.6	58	4.2	
Level 3								
Shangri-La Ballroom	590	540	240	270	18.5 x 24.6	456	4.8	
Shangri-La Ballroom 1	275	270	120	135	18.5 x 12.2	225	4.8	
Shangri-La Ballroom 2	275	270	120	135	18.5 x 12.4	229	4.8	
VIP Room 1	5	•	•	•	4.4 x 3.8	17	3.2	
VIP Room 2	5	•	•	•	5.7 x 3.8	22	3.2	
Secretariat	8	•	•	•	5.7 x 4.7	27	3.2	
Auditorium	•	•	•	93	16.1 x 13.0	209	6.4	
Pre-Function Area	•	•	•	•	36.7 x 6.6	439	•	
Guangdong Room	265	220	100	120	20.1 x 11.5	231	4.8	
Sichuan Room	140	120	80	66	12.4 x 10.0	124	3.8	
Jiangsu Room	140	120	80	66	12.0 x 12.2	146	3.8	
Zhejiang Room	70	50	40	33	8.9 x 7.6	68	3.8	
Liaoning Room	65	50	30	33	7.5 x 8.0	60	3.8	
Hunan Room	25	25	20	20	8.1 x 4.2	34	4.8	
Hebei Room	35	30	20	24	8.1 x 5.6	45	4.8	
Boardroom	•	•	•	•	9.3 x 7.5	70	4.8	
Level 4								
Rooftop Garden	200	•	120	•	•	300	•	
Level 40								
Chairman's Room	100	120	80	96	20.0 x 9.0	180	6.1	
Chairman's Terrace	60	•	60	•	20.0 x 9.0	180	6.1	

LEVEL 2

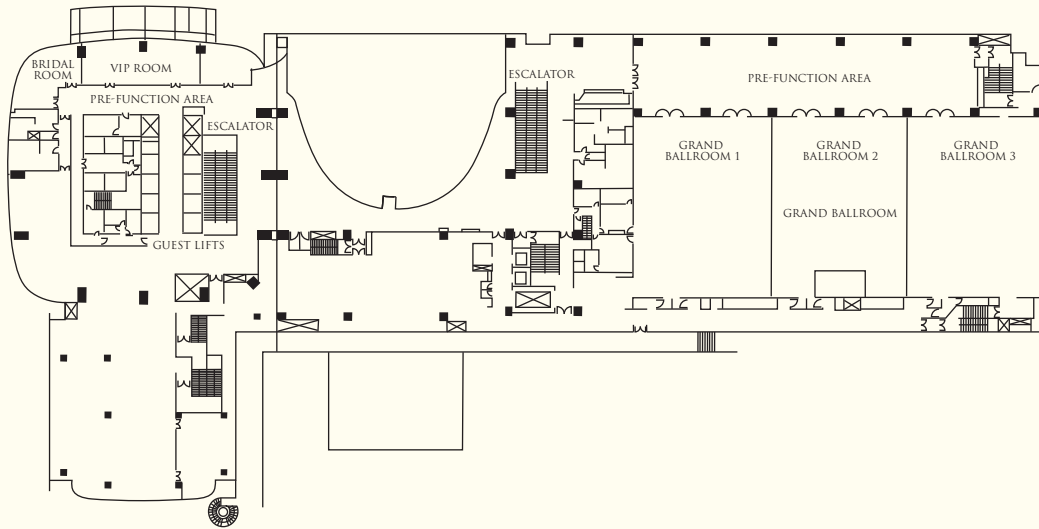

LEVEL 3

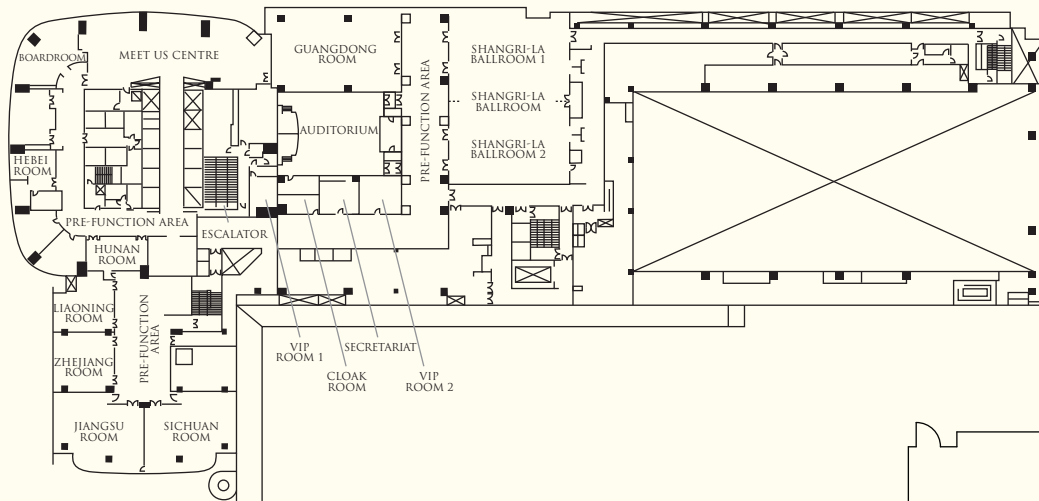

LEVEL 4

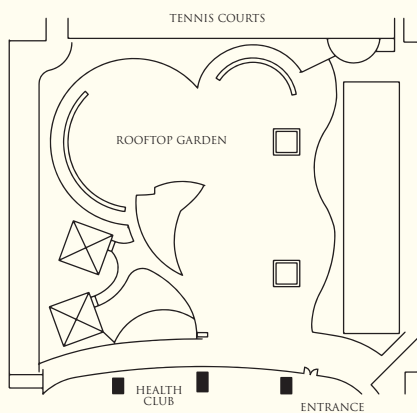

LEVEL 40

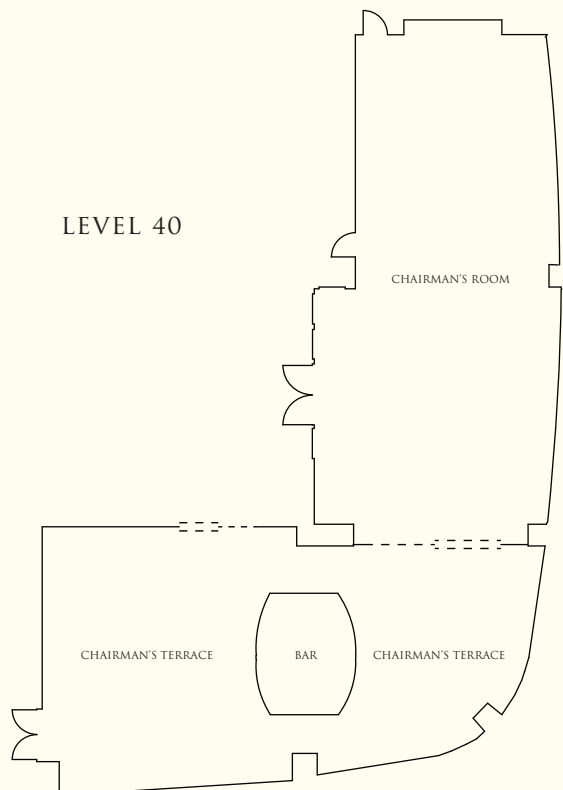



SHANGRI-LA

HOTELS *and* RESORTS

Futian Shangri-La, Shenzhen

4088 Yi Tian Road, Futian District, Shenzhen 518048, China

Tel: (86 755) 8828 4088 Fax: (86 755) 8828 4388 slft@shangri-la.com www.shangri-la.com