

# PRIVATE DINING ROOM FLOORPLANS

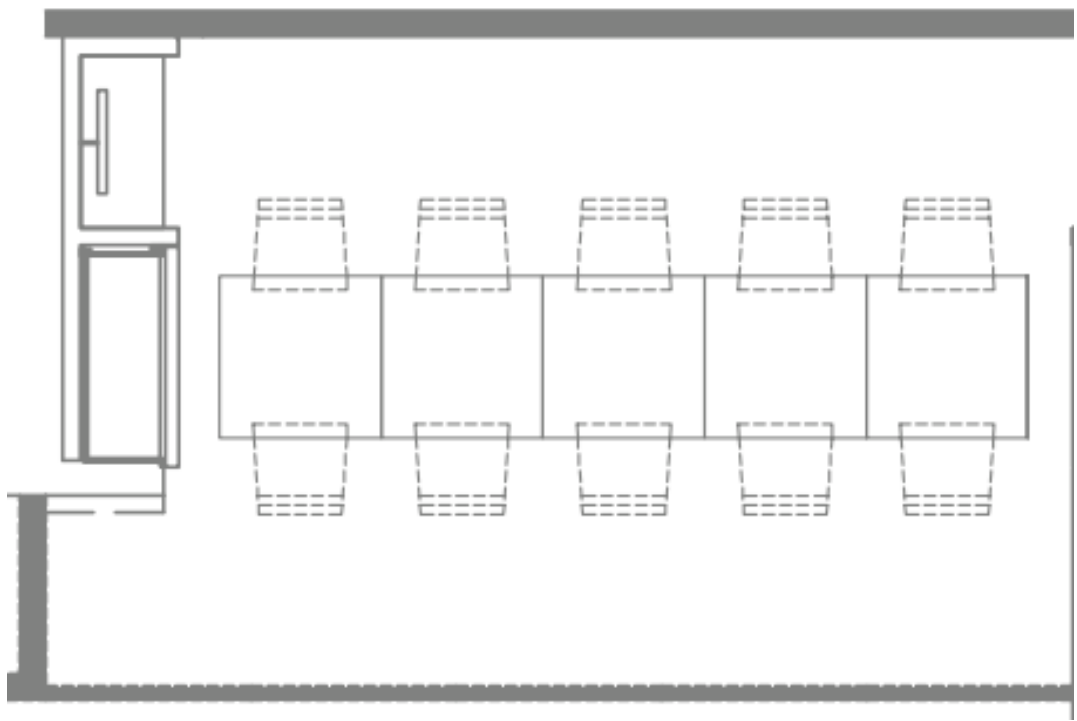

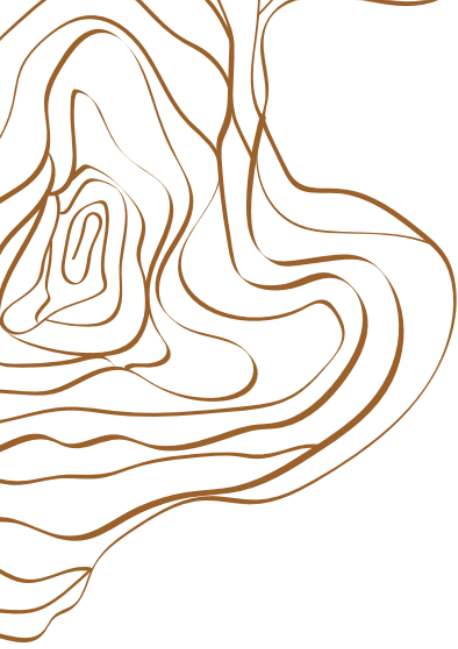

## Forbes

---

Seating Capacity: 10 persons

*\*Private dining room capacity is subject to change depending on government guideline of health and safety*



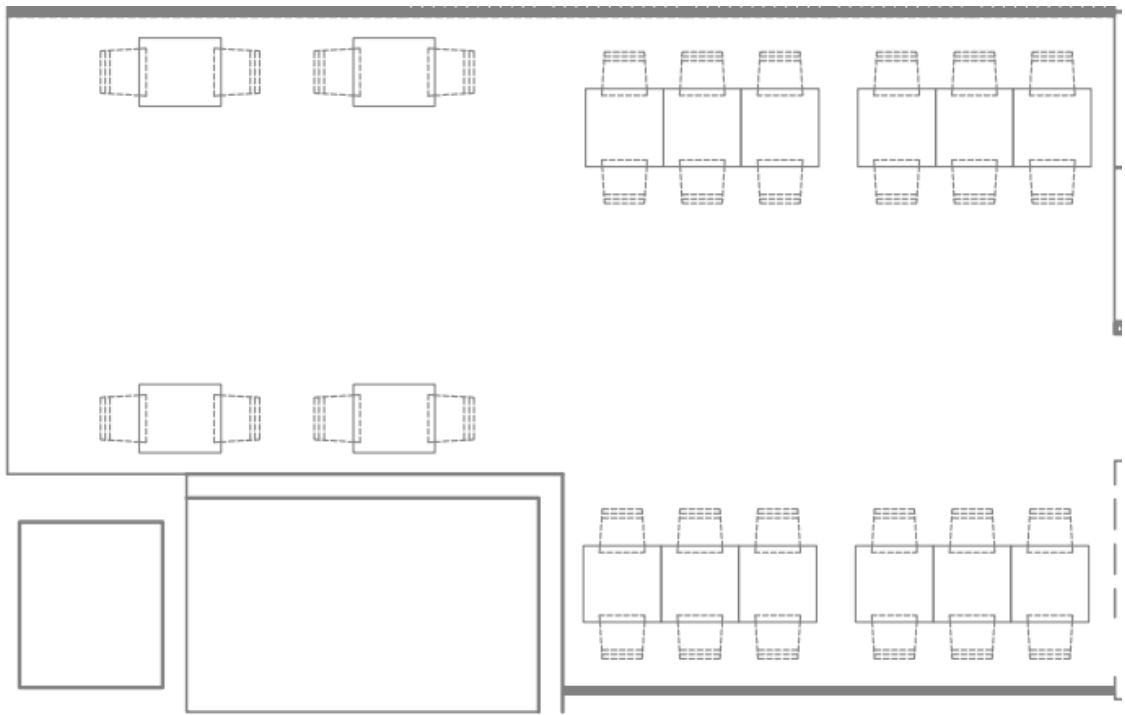

## Burgos

Seating Capacity: 25-35 persons

*\*Private dining room capacity is subject to change depending on government guideline of health and safety*



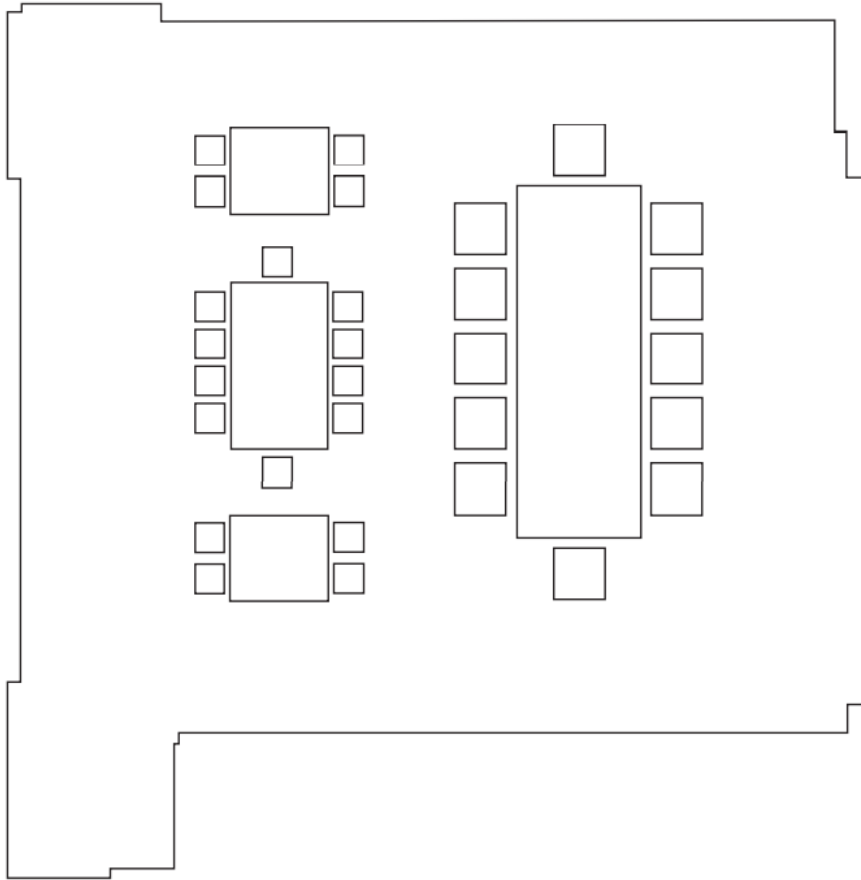
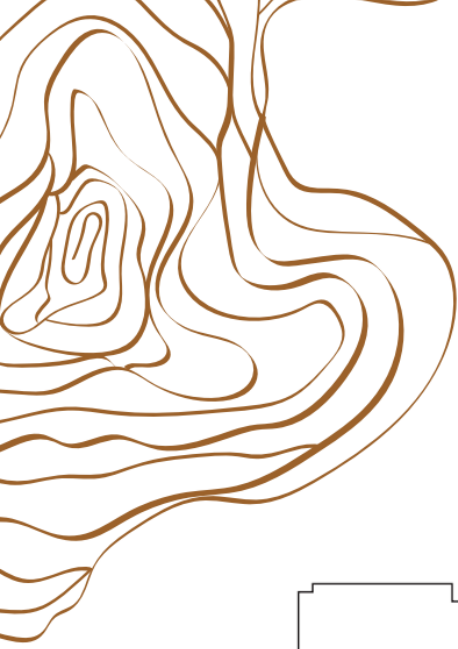

## Semi-Private Area

---

Seating Capacity: 40 persons

*\*Private dining room capacity is subject to change depending on government guideline of health and safety*

