



Meetings & Conferences Packages 2023

Full Day Package

9am - 5pm

PACKAGE A | RM300.00 ++ per person

- Use of main meeting room from 9am to 5pm
- Morning AND Afternoon coffee breaks daily with 3 types of snacks (Individual Serving)
- Conference Lunch
- Free flow of coffee/tea & water throughout the meeting
- Complimentary use of one flipchart and
- Complimentary use LCD projector and Screen in meeting room
- Meeting stationery and Mints throughout the meeting
- Hotel WIFI Internet Access
- * *Additional RM50.00++ per person to have lunch in Lemon Garden ((subject availability only)*

Half Day Package

9am - 1pm | 2pm - 5pm

PACKAGE B | RM280.00 ++ per person

- Use of main meeting room from 9am-1pm or 2pm-5pm
- Morning OR Afternoon coffee/tea breaks daily with 3 types of snacks (Individual Serving)
- Conference Lunch
- Free flow of coffee/tea & water throughout the meeting
- Complimentary use of one flipchart and
- Complimentary use LCD projector & Screen in meeting room
- Meeting stationery and Mints throughout the meeting
- Hotel WIFI Internet Access
- * *Additional RM50.00++ per person to have lunch in Lemon Garden ((subject availability only)*

PACKAGE C | RM240.00 ++ per person

- Use of main meeting room from 9am-1pm or 2pm-5pm
- Morning OR Afternoon coffee/tea breaks daily with 3 types of snacks (Individual Serving)
- Free flow of coffee/tea & water throughout the meeting
- Complimentary use of one flipchart and
- Complimentary use LCD projector & Screen in meeting room
- Meeting stationery and Mints throughout the meeting
- Hotel WIFI Internet Access

Contact us with your event requirements and leave the planning to us!

events.kualalumpur@shangri-la.com | +603 2032 2388

YOUR WELL-BEING IN OUR CARE

The well-being and safety of our guests and colleagues remains our top priority which is why we are putting additional tried-and-tested safeguards to elevate our already rigorous hygiene and safety standards. We are supported by our long-time partner, Diversey – a leading global hygiene solutions provider who has a century of experience and expertise in this field. We look forward to welcoming you back.



SAFE IN
YOUR HANDS



COVER UP



KEEPING A
SAFE DISTANCE



#ShangrilaCares

Learn more about the safety and cleanliness initiatives we have in place
www.shangri-la.com/cares/



MEETING UPGRADES LIVE STATION

- RM25.00++ per person per item to add on into coffee break session.
- Minimum 50 persons

MALAYSIAN:

- Freshly Wrapped Nyonya Popiah
- Ipoh Chicken Hor Fun
- Curry Laksa
- Penang Assam Laksa
- Nasi Lemak Bungkus
- Hainanese Kaya Toast and Half-Boiled Eggs
- Deep Fried Banana Fitter
- Fresh Fruits Rojak

ASIAN:

- Crab Meat Pai Tee
- Pulled Beef In Sesame Bun
- Xian Bread Pocket Stuffed with Braised Lamb
- Pan-Fried Shanghainese Sesame Pao
- California Hand Roll
- China Town Roasted Duck and Chicken
- Thai Mango Sticky Rice





MEETING UPGRADES LIVE STATION

- RM25.00++ per person per item to add on into coffee break session.
- Minimum 50 persons

WESTERN:

- Make Your Own Sandwiches
- Build Your Own New York Salmon Bagel
- Mini Burger with Condiments
- Long Sausage with Soft Bun and Condiments
- Egg Crepe Wrapped with Smoked Duck
- Egg Station:
Scrambled Eggs / Omelette / Hard & Soft Boiled





MEETING UPGRADES LIVE STATION

- RM25.00++ per person per item to add on into coffee break session.
- Minimum 50 persons

BEVERAGE:

- Teh Tarik
- Freshly Squeezed Fruits,
- Vegetables and Smoothies
- Bubble Milk Tea
- Ice Blended Coffee,
- Tea, Coco and Mocha



BANQUET AND CONFERENCE ROOMS

Venue	Reception	Capacity				Dimensions	Area	Ceiling Height
		Theatre	Banquet	Classroom	Boardroom	(m)	(m²)	(m)
BASEMENT II								
Grand Ballroom (Sabah + Sarawak)	1,800	1,800	1,440	660	-	34.7x43.5	1,509	6.7
Sabah	700	1,100	600	420	-	34.7x26.1	905	6.7
Sarawak	450	650	400	378	84	34.7x17.4	604	6.7
Junior Ballroom (Selangor Room + Melaka)	400	300	400	200	-	43x17.3	744	4
Selangor Room (Kedah + Selangor 1 + Perak)	360	270	340	160	-	26x17.3	449	4
Kedah	120	140	100	87	42	8.7x17.3	150	4
Selangor 1	120	140	100	87	42	8.7x17.3	150	4
Perak	120	140	100	87	42	8.7x17.3	150	4
Melaka	200	200	160	120	42	16.9x17.3	292	4
Perlis	25	30	27	18	18	8.7x5.2	45	4
Sabah Ante	-	60	40	36	18	9.6x8.3	80	3
Foyer	800	-	-	-	-	-	1,151	4
LOWER LOBBY								
Johor 1/2/3	45	60	40	33	18	8.7x7.1	61	3.7
Johor (Johor 1+2+3)	140	160	120	100	60	26x7.1	184	3.7
Grand Johor (Johor 1+2+3+4+5+6)	360	270	340	160	-	26x15.8	410	3.7
Johor 1+4 / 2+5 / 3+6	120	140	100	87	42	8.7x15.8	137	3.7
Kelantan	70	80	50	45	36	6.2x14.1	87	3.7
Penang	80	90	50	48	36	6.2x16.1	100	3.7
Foyer	400	-	-	-	-	-	620	3.7
LEVEL 1								
Mezzanine 1,2&3	-	-	-	-	14	8.8x3.6	32	3.0
Mezzanine 4	-	-	-	-	8	3.5x5.7	20	3.0

BANQUET AND CONFERENCE ROOMS

BASEMENT II

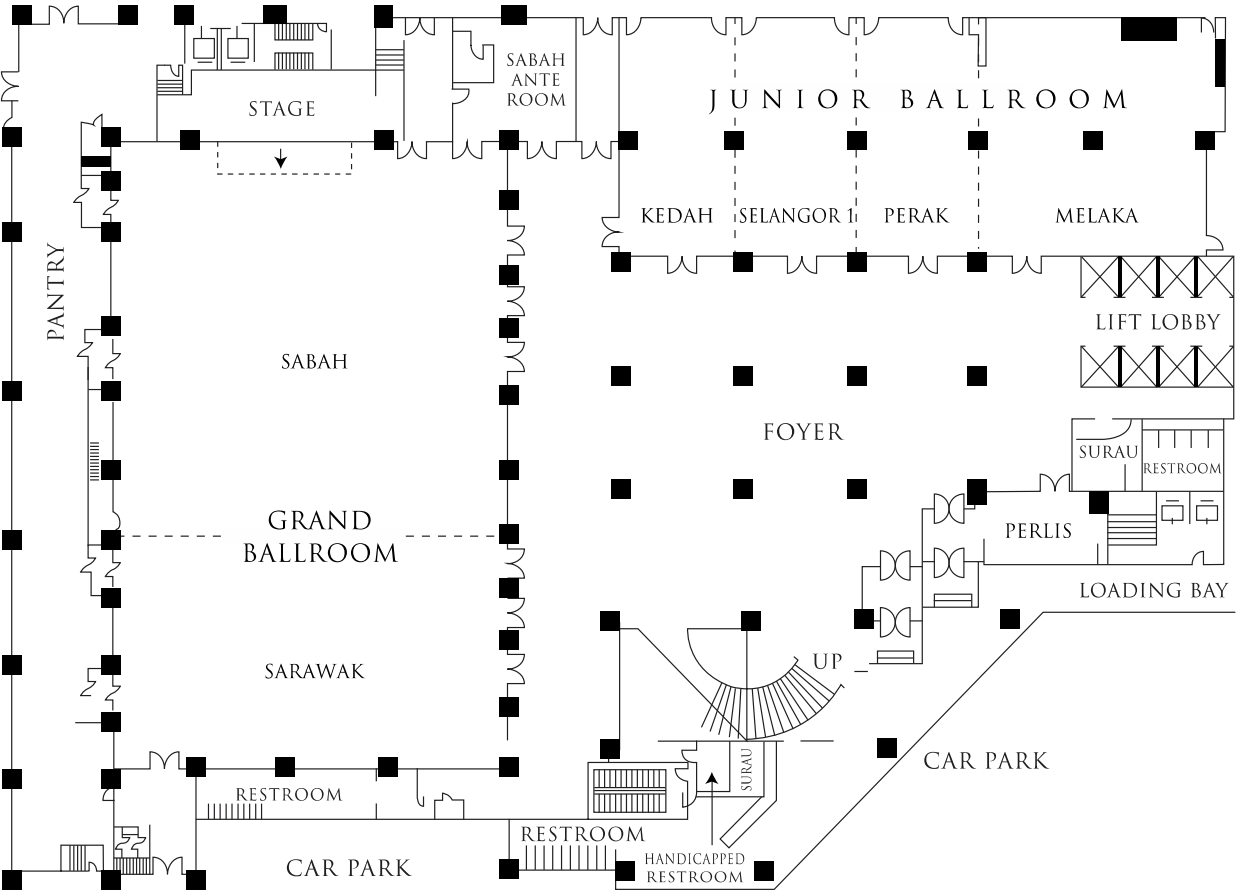

BANQUET AND CONFERENCE ROOMS

LOWER LOBBY

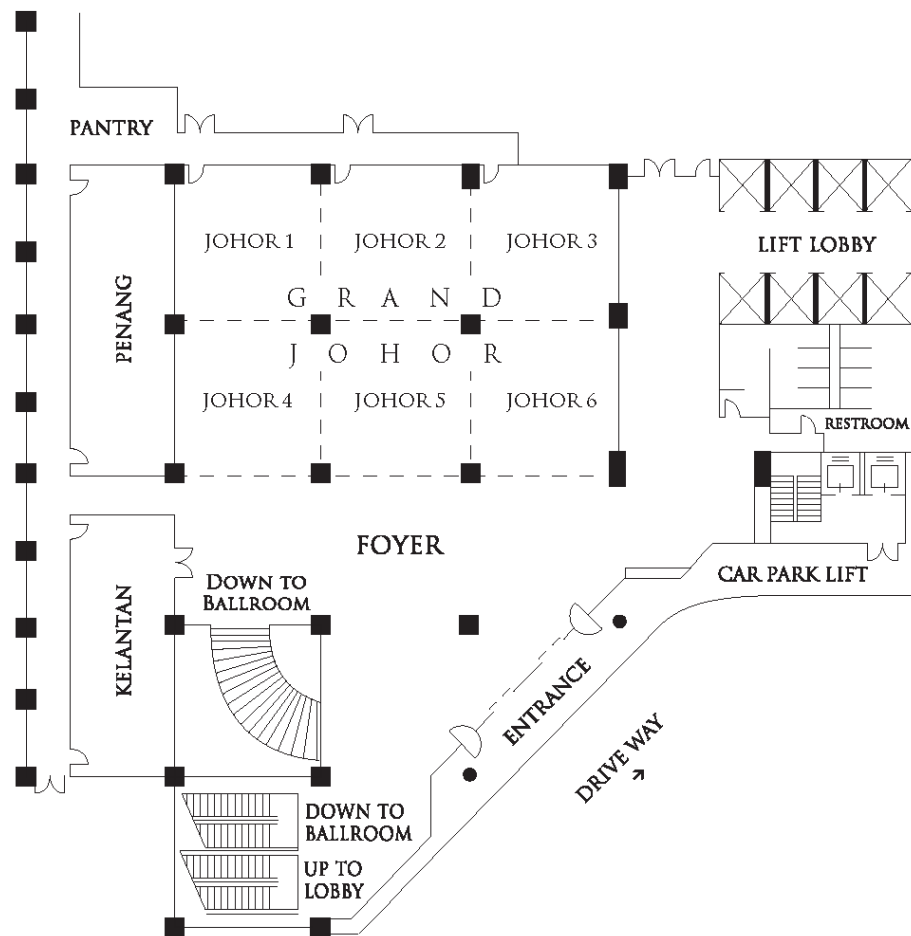

LEVEL I

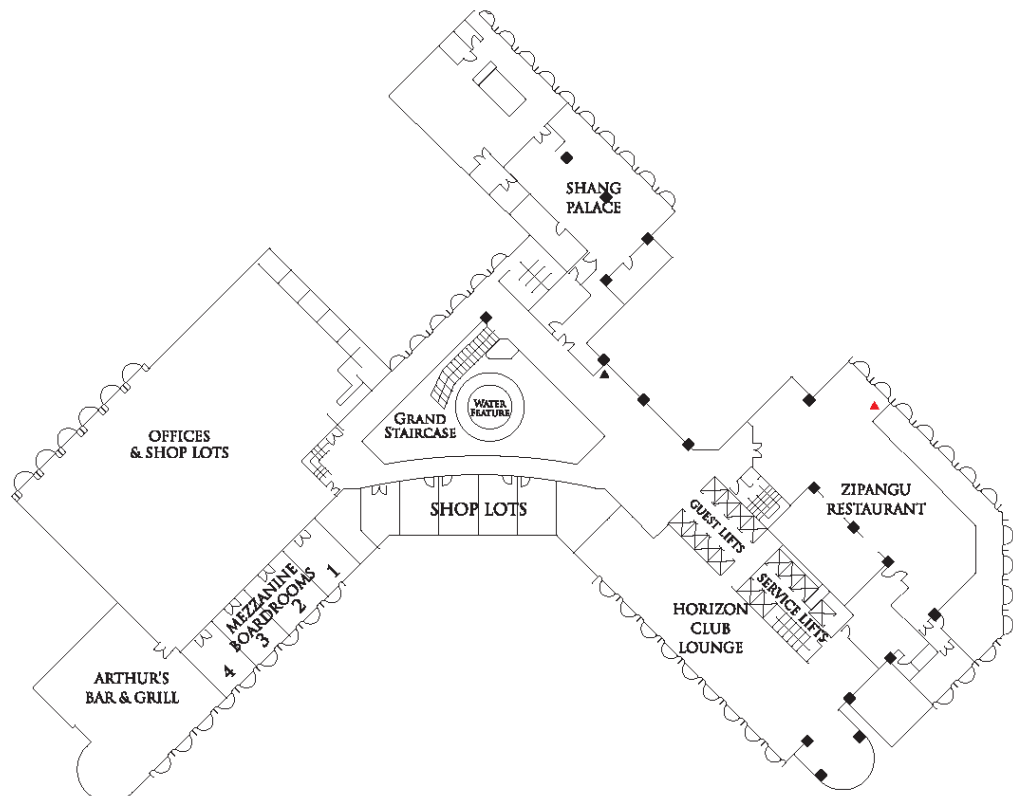



Contact us with your event requirements
and leave the planning to us!

events.kualalumpur@shangri-la.com

+603 2032 2388



SHANGRI-LA
KUALA LUMPUR

11 Jalan Sultan Ismail, 50250 Kuala Lumpur, Malaysia. www.shangri-la.com