



## FACTS AND INFORMATION

SHANGRI-LA HOTEL, QUFU

## LOCATION

Conveniently located in the city centre, Shangri-La Hotel, Qufu is within walking distance to the Temple of Confucius and the Kong Family Mansion, making it an ideal base to explore this culturally-rich city – the birthplace of Confucius, the famous Chinese thinker and educator. Qufu’s high-speed train station connecting to Beijing and Shanghai is just 15 minutes away. Domestic and international airports are located in the neighbouring cities of Jining and Jinan.

## ACCOMMODATION

The hotel comprises two expansive wings, the East Wing and the West Wing. The East Wing offers a total of 325 rooms and suites, including the exclusive Horizon Club. All rooms feature modern and elegant décor, and with a minimum size of 42 square metres, by far the largest in the city. River View rooms each offers private balcony with tranquil views of the adjacent Little Yi River and the hotel’s lush landscaped gardens.

## GUESTROOMS

Categories	Rooms	Area (m <sup>2</sup> )
<b>East Wing</b>		
Deluxe Room	124	42
Deluxe River View Room	146	42
Horizon Club Deluxe Room	18	42
Horizon Club Deluxe River View Room	17	42
Executive Suite	16	84
Deluxe Suite	3	126
Specialty Suite	1	168

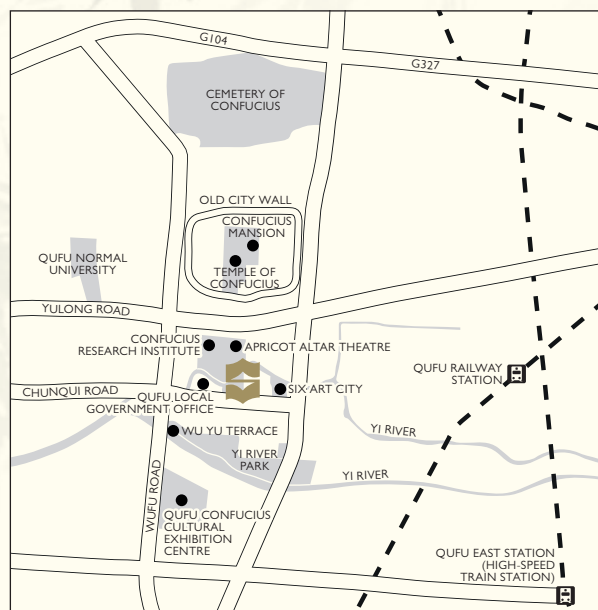

## GUESTROOM FEATURES

- Complimentary broadband wired and Wi-Fi Internet access
- Satellite / cable 40-inch LCD television
- Electronic in-room locker
- Bedside lighting controls
- Shangri-La toiletries
- Full size executive writing desk
- Minibar
- Hair dryer
- International Direct Dial telephone
- Voice mail
- Iron and ironing board
- Tea / coffee making facilities
- Separate shower cubicles and bathtub
- Feather duvet and pillows
- Pillow menu with hypoallergenic options (Horizon Club rooms and suites only)

## HORIZON CLUB PRIVILEGES

- Private check-in and check-out at the top floor Horizon Club Lounge on level 17
- Late check-out at 6pm
- Complimentary access to the Horizon Club Lounge from 6am to 11pm
- Complimentary buffet breakfast, evening cocktails and canapé selections
- Complimentary coffee, juices and soft drinks during the day
- Concierge service
- Complimentary daily international newspaper
- One complimentary suit pressing upon arrival

## RECREATION FACILITIES

- Fully-equipped health club and gymnasium
- Indoor swimming pool
- Outdoor tennis court
- Jacuzzi, sauna and steam rooms
- Full spa services and private treatment rooms

## BUSINESS CENTRE

The hotel provides business centre facilities with a range of secretarial support such as faxing, photocopying, courier and translation services, broadband Internet access and private working stations.

## RESTAURANTS AND BARS

Restaurants / Bars	Capacity	Location	Cuisine
Lobby Lounge	84	Level 1, Main lobby	Beverages and snacks
Café Kong	298	Level 1, East Wing	International
Shang Palace	170	Level 1, West Wing	Cantonese, Shandong Regional Lu and signature Kong Family
Grain House	134	Level 1, West Wing	Casual Chinese dining, favorite local, regional and specialty dishes
Streaming Bar	30	Level 1, West Wing	Beverages and snacks

## OTHER SERVICES AND FACILITIES

- Conference and banqueting facilities featuring 1,600 square metres Qilu Grand Ballroom, the Thinking and Learning Garden, an outdoor terrace, plus a choice of 15 spacious function rooms for 10 to 280 people
- 24-hour in-room dining
- Facilities for the physically challenged
- Non-smoking rooms
- Gift and retail shop
- Courier, parcel and postal service
- Laundry and valet service
- Limousine service
- Baby-sitting / child care
- Tour guide arrangement
- IT butlers
- Outdoor terrace dining
- Outdoor and underground car park
- Air ticketing service
- Foreign exchange



WEST WING  
Level 1

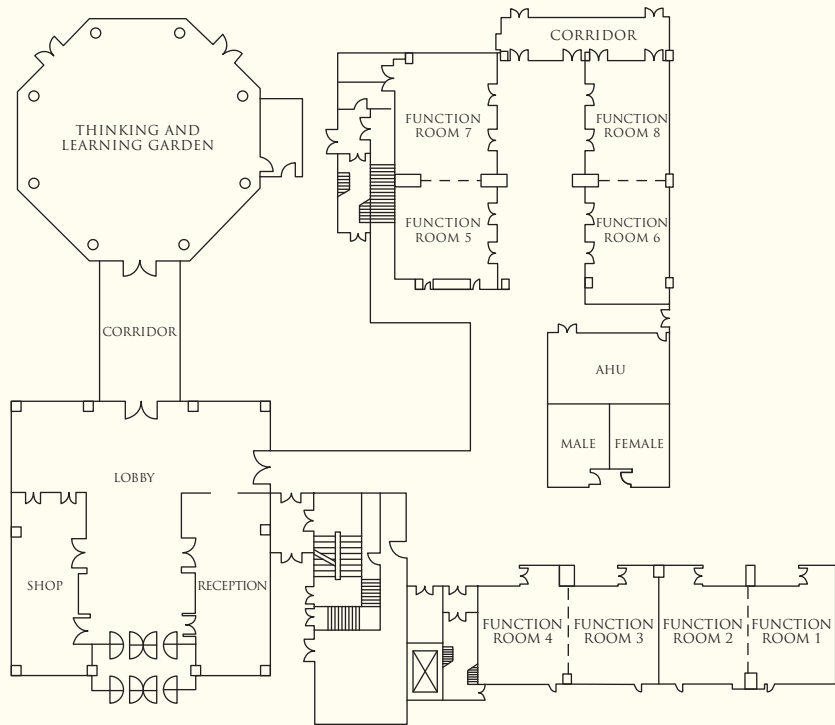

Level 2

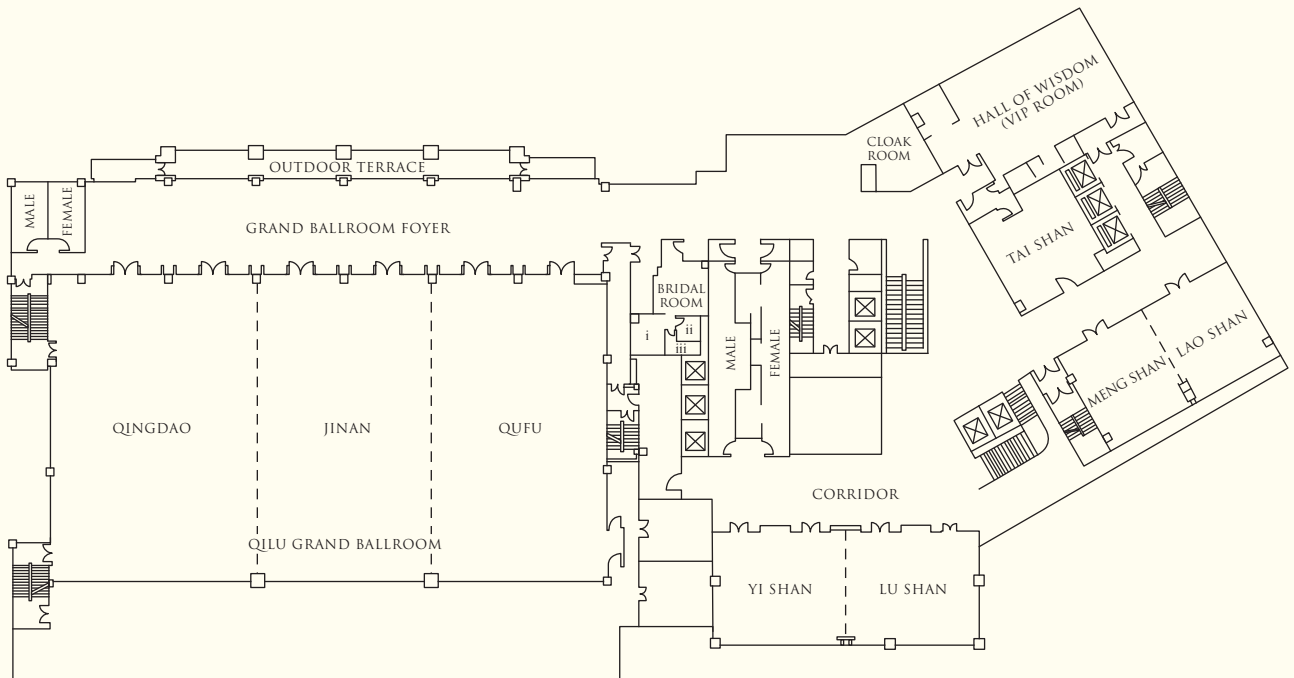

- i Make-up room
- ii W.C.
- iii Shower room



**SHANGRI-LA**

HOTELS *and* RESORTS

Shangri-La Hotel, Qufu

3 Chunqiu Road, Qufu, Shandong 273100, China

Tel: (86 537) 505 8888 Fax: (86 537) 505 5616 [slqf@shangri-la.com](mailto:slqf@shangri-la.com) [www.shangri-la.com](http://www.shangri-la.com)