



## FACTS AND INFORMATION

SHANGRI-LA HOTEL, LHASA

## LOCATION

Shangri-La Hotel, Lhasa is situated amidst striking mountain landscape and is just minutes from the Norbulingka Palace and the Potala Palace, both part of the "Historic Ensemble of the Potala Palace", a UNESCO World Heritage Site. The Buddhist temple monastery of the Potala Palace was built in the 7th century as the Dalai Lama's winter residence. Norbulingka Palace was built in 1755 and served as the traditional summer residence.

Lhasa is the capital and largest city in Tibet and means "Place of God". It sits on Qinghai-Tibetan plateau on the banks of the Lhasa River at an altitude of 3,650 metres above sea level, and is one of the highest inhabited regions on earth. The city is surrounded by the Himalaya mountain range and has over 1,300 years of history.

Guests can reach the city by train on the world's highest railway, or by air to the Lhasa Gonggar Airport just 50 kilometres from the city centre. The hotel is located right in the centre of Lhasa city, a 10-minute drive from the Lhasa Railway Station.

## ACCOMMODATION

The hotel comprises 262 contemporary guestrooms and 17 expansive suites, as well as the exclusive Horizon Club Lounge. Rooms are spacious with a minimum size of 43 square metres and suites provide up to 86 square metres of luxurious space. Guests can enjoy stunning views of the Potala Palace or the breathtaking mountains and can relax in the comforts of traditional Tibetan architecture and interior design. 10 units of one or two-bedroom long-stay apartments are also available with 86 to 129 square metres of comfortable living space.



## GUESTROOM FEATURES

- Complimentary Wi-Fi Internet access
- Satellite / cable 40-inch LED television
- Electronic in-room locker
- Sofa settees and lounge table
- Mini-bar
- Hair dryer
- International Direct Dial telephone
- Voice mail
- Iron and ironing board
- Tea / coffee making facilities
- Shower cubicle with wash basin
- Feather duvet and pillows
- Pillow menu with hypoallergenic options

## GUESTROOMS

Categories	Rooms	Area (m <sup>2</sup> )
Deluxe Room	191	43
Premier Room	30	56 - 64
Horizon Club Room	41	43 - 54
Execuitve Suite	14	86
Deluxe Suite	2	124
Presidential Suite	1	250
1-Bedroom Apartment	6	86
2-Bedroom Apartment	4	171

## HORIZON CLUB PRIVILEGES

- Private check-in and check-out at the Horizon Club Lounge
- Late check-out at 4pm
- Complimentary access to the Horizon Club Lounge from 6am to 10pm
- Complimentary buffet breakfast, evening cocktails and canapé selections
- Complimentary coffee, juices and soft drinks during the day
- Concierge service
- Complimentary daily international news print
- One complimentary suit pressing upon arrival

## ROUTES

Routes, a one-stop self-service lounge, provides guests with comprehensive and convenient information on tours and transportation, as well as business support services including fully equipped working stations and complimentary broadband Internet access.

## RECREATION FACILITIES

- Fully-equipped health club and gymnasium
- Indoor swimming pool
- Oxygen lounge
- Reflexology pavilion
- CHI, The Spa – Shangri-La's signature spa services and private treatment rooms

## OTHER SERVICES AND FACILITIES

- 24-hour in-room dining
- Air ticketing service
- Baby-sitting / child care
- Courier, parcel and postal service
- Facilities for the physically challenged
- Foreign exchange
- Gift and retail shop
- IT butlers
- Laundry and valet service
- Limousine service
- Medical clinic
- Non-smoking rooms
- Outdoor terrace dining
- Tour guide arrangement
- Indoor and outdoor car park

## RESTAURANTS AND BARS

Restaurants / Bars	Capacity	Location	Cuisine
Altitude	180	Level 3	Local and international cuisine
Shang Palace	184	Level 1	Cantonese and Sichuan cuisine
Shambala	102	Level 3	Tibetan-Yunnan tapas bar and lounge
Lodgers Lounge	118	Level 3	Beverages and snacks

## BANQUET AND CONFERENCE ROOMS

Venue	Capacity						Dimensions (m)	Area (m <sup>2</sup> )	Ceiling Height (m)
	Reception	Theatre	Banquet	Classroom	U-shape	Board Room			
<b>Level 3</b>									
Grand Ballroom	800	1,150	700	750	•	•	45 x 27	1,215	6.8
Grand Ballroom Foyer	•	•	•	•	•	•	49 x 7	343	4.5
Grand Ballroom 1	300	450	240	290	180	•	18 x 27	486	6.8
Grand Ballroom 2	150	250	120	120	120	•	9 x 27	243	6.8
Grand Ballroom 3	300	450	240	290	180	•	18 x 27	486	6.8
Changtse	100	150	80	80	60	50	9 x 18	162	3.9
Melungtse	50	•	40	•	•	•	9 x 9	81	3.9
Kawagarbo	70	110	60	60	50	30	11 x 10	110	4.8
Cho Oyu	70	110	60	60	50	30	11 x 10	110	4.8
Tanggula	70	110	60	60	50	36	7 x 15	105	4.8
<b>Level 5</b>									
Makalu	70	80	40	40	30	20	9 x 9	81	3.0
Lhotse	100	150	80	80	60	50	10 x 15	150	3.0

## LEVEL 5 - FUNCTION ROOMS

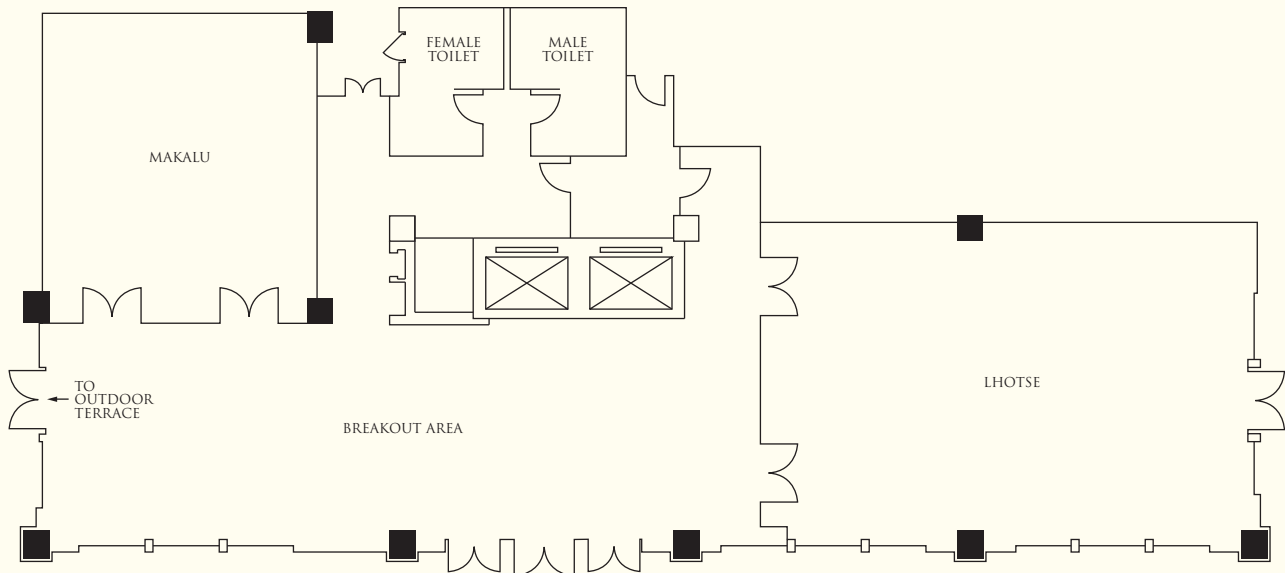

LEVEL 3 - BALLROOM

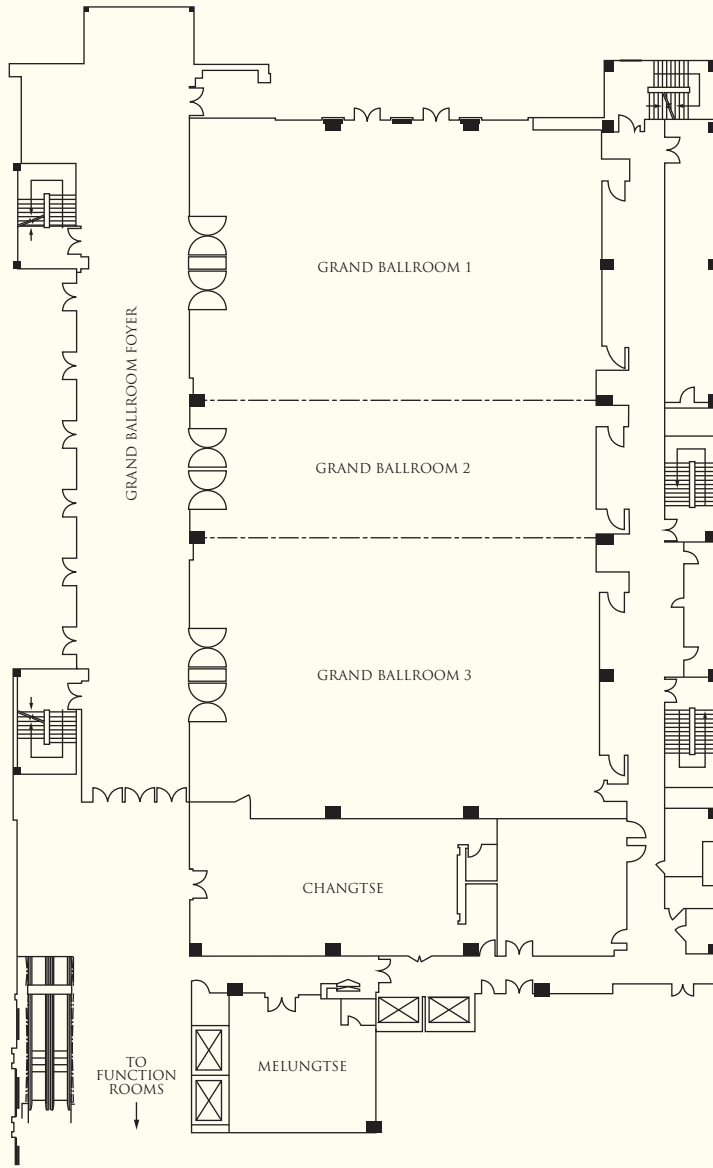

LEVEL 3 - MULTI FUNCTION ROOMS

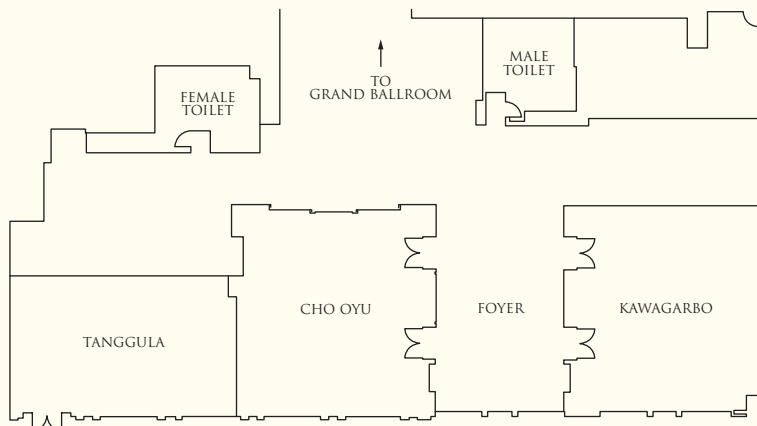



**SHANGRI-LA**

HOTELS *and* RESORTS

Shangri-La Hotel, Lhasa

19 Norbulingka Road, Lhasa, Tibet Autonomous Region, 850000 China

Tel: (86 891) 655 8888 Fax: (86 891) 667 9999 [slls@shangri-la.com](mailto:slls@shangri-la.com) [www.shangri-la.com](http://www.shangri-la.com)