

Hotel Fact Sheet

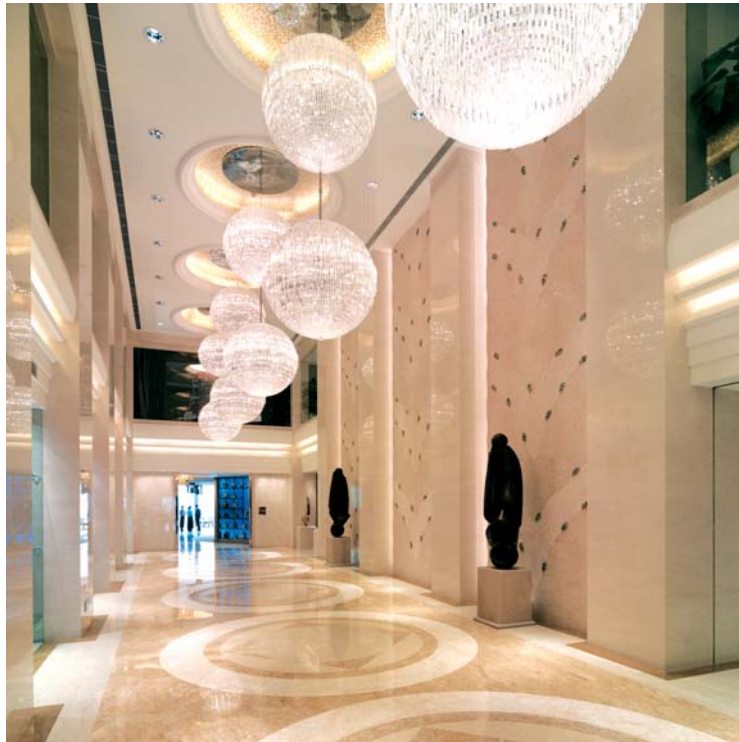

Shangri-La hotel

SUZHOU, CHINA

LOCATION

Occupying the upper 24 levels of the tallest building in Jiangsu Province, the 232-metre high Metropolitan Tower, Shangri-La Hotel, Suzhou is the first international deluxe hotel in the Suzhou New District. It is a convenient 10-minute car ride to the Shanghai Nanjing highway, 15 minutes to Suzhou Railway Station and a mere 2-minute walk to the commercial and entertainment establishments of the Suzhou New District Business Street, Huai Hai Street.

ACCOMMODATION

The hotel features 390 tastefully appointed guestrooms including 90 Horizon Club rooms and 30 suites. With a minimum floor space of 42 square metres and a ceiling height of more than three metres, the guestrooms are the largest in town, offering spectacular views of the city. In addition, there are 20 serviced apartments with fully fitted kitchenettes to cater to the different needs of guests.

GUESTROOMS

Categories	Rooms	Area (m ²)
Deluxe Room	245	42
Premier Room	35	62
Horizon Deluxe Room	63	42
Horizon Premier Room	17	65
Executive Suite	17	82
Horizon Executive Suite	10	82
Diplomatic Suite	1	114
Speciality Suite	1	144
Presidential Suite	1	228

GUESTROOM FEATURES

All guestrooms offer a wide range of luxurious amenities and facilities including:

- 24-hour room service
- Tea / coffee making facilities
- Mini-bar
- Satellite / cable television
- Voice mail
- Computer data port
- Complimentary broadband Internet access
- Electronic safe
- Hairdryer
- Iron / ironing board

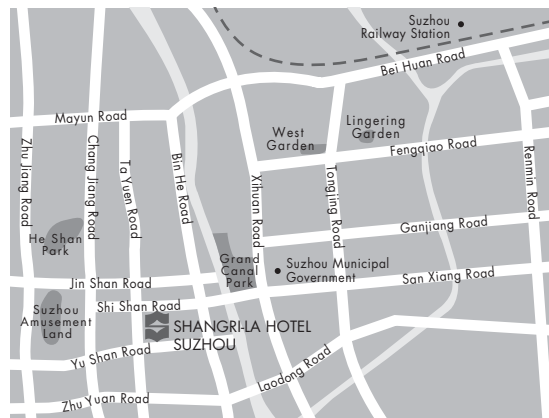

HORIZON CLUB PRIVILEGES

On Horizon Club floors, the following exclusive benefits are provided:

- Express check-in and check-out services
- Private Horizon Club lounge
- Complimentary breakfast and evening cocktails
- DVD players in each guestroom
- Personal butler service upon request

BUSINESS CENTRE

Every business convenience is on offer at the fully equipped business centre, from translation and secretarial support to Internet access and video conferencing. Private meeting rooms and offices are also available upon request.

RECREATION FACILITIES

- Health Club
- Spa with six private treatment rooms
- Jacuzzi, sauna and steam bath
- Indoor swimming pool
- Two outdoor tennis courts
- Golf putting green

OTHER SERVICES AND FACILITIES

- Car parking
- Concierge and postal / courier services
- Same day laundry service
- Air and train ticket reservations

RESTAURANTS AND BARS

Restaurants / Bars	Capacity	Location	Cuisine
Café Soo	206	Lobby level	Continental / Asian, with open kitchen
Deli Soo	30	Lobby level	Western / Asian
Restaurant Suntory	116	Lobby level	Japanese
Lobby Lounge	78	Lobby level	Cocktails / Beverages / Snacks
Shang Palace	208	Level 2 and 3	Cantonese / Huai Yang / Local cuisine
Club Red Bar	214	Level 3	Entertainment Centre / Bar

BANQUET AND CONFERENCE ROOMS

Venue	Capacity					Dimensions (m)	Area (m ²)	Ceiling Height (m)
	Reception	Theatre	Banquet	Classroom	Boardroom			
Level 1								
Lobby	60	-	-	-	-	15 x 20	300	3.5
The Auditorium	-	120	-	-	-	16 x 16	240	3.2
Auditorium Foyer	100	-	-	-	-	8 x 40	320	3.5
Yuan Xiang	50	70	72	54	-	8 x 14.5	110	3.5
Jian Shan	50	70	72	54	-	8 x 14.5	110	3.5
He Feng	30	32	30	27	-	8 x 8	64	3.5
Zhui Yun	30	32	30	27	-	8 x 8	64	3.5
Tong Zuo	30	32	30	27	-	8 x 8	64	3.5
Level 2								
Reception	-	-	-	-	-	16 x 8.5	136	3.5
The Grand Ballroom	1,200	900	800	650	-	53.5 x 24.5	1,310	8
Grand Ballroom Foyer	200	-	-	-	-	56 x 7.5	420	-
Grand Ballroom I	350	260	220	160	-	16 x 24.5	392	8
Grand Ballroom II	350	260	220	160	-	16 x 24.5	392	8
Grand Ballroom III	400	340	260	240	-	21.5 x 24.5	526	8
The Metropolitan Ballroom	350	300	220	210	-	19.5 x 24.5	478	8
Metropolitan Ballroom Foyer	-	-	-	-	-	25 x 5	125	3.5
Metropolitan Ballroom I	160	140	120	96	-	19.5 x 12.25	239	8
Metropolitan Ballroom II	160	140	120	96	-	19.5 x 12.25	239	8
The VIP Lounge	150	120	100	72	-	13.5 x 15.5	210	3.5
Level 3								
Boardroom	-	-	-	-	20	8.5 x 5	43	2.6



Worldwide Reservations

For reservations, please contact our reservations offices, your travel consultant or book on-line at:

www.shangri-la.com

All numbers are TOLL-FREE

except where indicated.

AUSTRALIA		1 800 222 448	MALAYSIA	1300 88 7388
AUSTRIA		0800 29 1619	MEXICO	001 800 514 2878
BAHRAIN		8000 4002	NETHERLANDS	0800 022 4038
BELGIUM		0800 711 03	NEW ZEALAND	0800 442 179
CANADA		1 866 344 5050	NORWAY	800 18 225
MAINLAND CHINA	Northern Provinces [†]	10 800 852 5900	PHILIPPINES	00 800 8388 8388
	Southern Provinces [#]	10 800 152 5900	SAUDI ARABIA	800 844 4309
HONG KONG SAR [*]		2331 6688	SINGAPORE	001 800 8388 8388
DENMARK		8088 5399	SOUTH AFRICA	0800 999 007
EGYPT		888 419 6469	SOUTH KOREA	00798 601 8228
FINLAND		0800 11 6073	SPAIN	900 997 068
FRANCE		0800 90 8153	SULTANATE OF OMAN	800 70 102
GERMANY		0800 181 8026	SWEDEN	020 795171
INDIA		000 800 600 1107	SWITZERLAND	0800 561 185
INDONESIA		001 803 606 280	TAIWAN	008 0185 5818
ITALY		800 786 567	THAILAND	1 800 06 0020
JAPAN		0120 944 162	UNITED ARAB EMIRATES	800 0600 0201
MACAU SAR		0800 880	UNITED KINGDOM	0800 028 3337
			UNITED STATES OF AMERICA	1 866 565 5050

[†] including Beijing, Tianjin, Northeast Provinces

[#] including Shanghai, Guangdong, Sichuan, Xian

^{*} Non toll-free number

GDS Chain Code: SG



Shangri-La hotel

SUZHOU, CHINA

168 Ta Yuan Road, Suzhou National New & Hi-Tech Industrial Development Zone, Suzhou 215011, China

Tel: (86 512) 6808 0168 Fax: (86 512) 6808 1168

E-mail: slsz@shangri-la.com Website: www.shangri-la.com