

FACTS AND INFORMATION



SHANGRI-LA HOTEL, SINGAPORE

SHANGRI-LA HOTEL, SINGAPORE

HOTEL FACT SHEET

COMPANY PROFILE

Regularly voted among the top hotels in the world, Shangri-La Hotel, Singapore is where the hotel brand began.

Whether you explore the rich tapestry of local culture, escape to a lush urban retreat or relax inside an indoor tropical garden at the hotel lobby, there is an abundance of experiences to be discovered at Shangri-La Hotel, Singapore. Discerning travellers can select from 792 elegantly-appointed rooms and suites at any of our distinctive wings: the contemporary Tower Wing, the resort-like Garden Wing, or the prestigious Valley Wing. The hotel is just a walk away from the prime shopping district of Orchard Road.

Enhanced with modern amenities, a completely rejuvenated Tower Wing lobby, refreshed guestrooms and suites, a new Horizon Club Lounge, and vibrant dining options, Shangri-La Hotel, Singapore's story now continues with you.

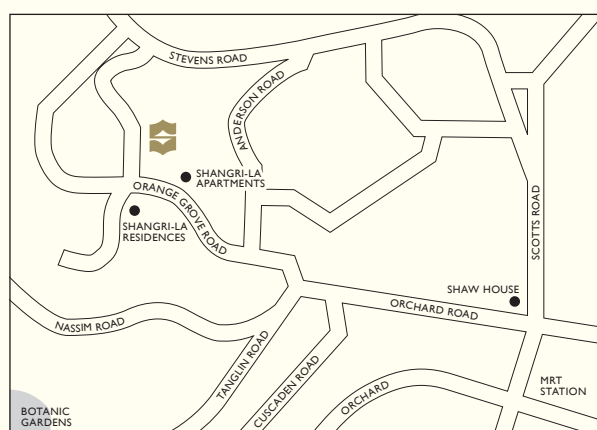

LOCATION

Shangri-La Hotel, Singapore is well situated within Singapore's extensive network of buses and trains, and it is only a 10-minute drive to the CBD and 30 minutes to Changi International Airport.

ACCOMMODATIONS

The hotel comprises 792 elegant guestrooms and suites with three distinctive wings: the urban resort Garden Wing, set amongst lush tropical foliage; the contemporary Tower Wing which houses the executive Horizon Club rooms and family-friendly facilities, including 5 Themed Family Suites and a dedicated family floor, and the exclusive Valley Wing for the discerning traveller. 127 service apartments and 55 luxurious condominium units are also available for longer staying guests.

GUESTROOMS

Categories	Rooms	Area (m ²)
------------	-------	------------------------

Tower Wing

Tower Deluxe	358	38
Horizon Deluxe	81	38
Horizon Grand Premier	34	67
One Bedroom Suite	5	82
Family Deluxe	19	38
Themed Family Suite	5	72
Grand Suite	1	250

Garden Wing

Deluxe (City/Pool View)	146	50
1 Bedroom Suite	9	81
Premier Balcony Suite	3	137

The Valley Wing

Deluxe (City/Pool View)	105	57
1 Bedroom Suite	11	79
Deluxe Suite	12	110
Singapore Suite	2	238
Shangri-La Suite	1	348

GUESTROOM FEATURES

- Complimentary broadband Internet access and Wi-Fi
- 24-hour in room dining
- Satellite/cable television with in-house movie channels
- IDD telephone and voice mail
- Full-size executive desk
- In-room safe
- Fully stocked mini bar
- Tea and coffee making facilities
- Shangri-La branded toiletries
- Iron and ironing board
- Hair dryer

THEMED FAMILY SUITES AND DELUXE FAMILY ROOMS

- A dedicated central pantry on Level 9
- Stokke and other family services, amenities and features
- Family Concierge
- Complimentary access to Buds by Shangri-La, Level 1, Tower Wing

HORIZON CLUB PRIVILEGES

- Personalised check-in and check-out at the exclusive lounge, with option of late check-out until 4pm on the day of departure*
- Complimentary buffet breakfast, evening cocktails and canapés
- Complimentary coffee, tea, juices and soft drinks served throughout the day
- Concierge service
- Full-size executive desk
- Pillow menu
- Complimentary suit pressing upon arrival
- Tea, coffee or a hot beverage of your choice to be delivered to your room with your wakeup call

*subject to availability

GARDEN WING PRIVILEGES

All rooms in the Garden Wing exude a sense of tranquillity with interior design inspired by nature. Three Premier Balcony Suites are available for the ultimate retreat. Each suite is fitted with an outdoor Jacuzzi, private barbecue grills and sun lounges on a large balcony. Guests of Garden Wing can enjoy these privileges:

- A private balcony
- Complimentary broadband and wireless Internet access
- Pillow menu

THE VALLEY WING PRIVILEGES

The accommodation of choice for heads of states, captains of industries and discerning travellers, the Valley Wing epitomises the very best of luxury accommodation in Singapore. From arrival to departure, guests in the Valley Wing can enjoy an unparalleled level of luxurious amenities and personalised services:

- Complimentary champagne and cocktails throughout the day
- Complimentary breakfast in the Summit Room
- Complimentary broadband wireless Internet access
- Complimentary minibar, excluding alcoholic beverages and snacks
- Private business centre at the Valley Wing lobby
- In-room all-in-one fax, printer and copier
- Choice of mood lighting in the bathroom
- Pillow menu
- Personalised stationery
- Private entrance and lobby
- Butler service (for suites)

CHI, THE SPA AT SHANGRI-LA

Singapore's first CHI, The Spa is set amidst 15 acres of lush landscaped gardens abundant with trees, flowering plants and a cascading waterfall. The spa features 4 single and 3 couple treatment rooms and an extensive menu where holistic treatments are based on time honoured methods shared by many Asian cultures.

RECREATION FACILITIES

- Fully-equipped health club and 24-hour gymnasium
- Outdoor swimming pool
- Children's play pool
- Indoor kids club (Buds by Shangri-La)
- Outdoor playground
- Jacuzzi (warm)
- Sauna and steam room
- Floodlit tennis court
- Self-guided orchid / garden tours

OTHER SERVICES AND FACILITIES

- Complimentary scheduled shuttle bus services to the central business district and Orchard Road
- Airport transfer
- Airport concierge
- Non-smoking rooms
- Wheelchair-accessible rooms
- Babysitting / childcare services
- Limousine and taxi services
- Parking facilities
- Foreign currency exchanges
- Safety deposit boxes
- Laundry and valet service
- Hair and beauty salon
- Florist
- Hairdresser
- Handicap room
- DVDs (upon request)

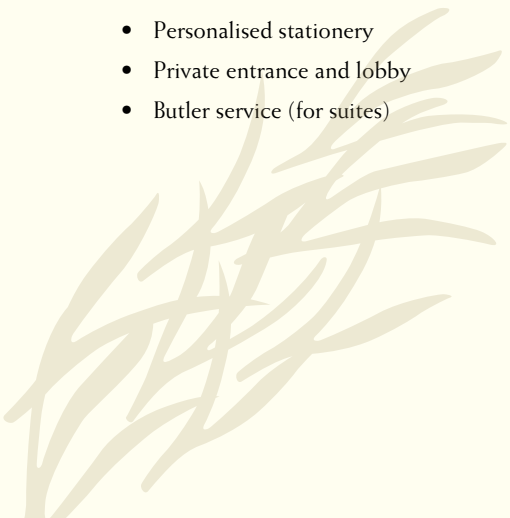

MEZZANINE LEVEL

Venue	Capacity & Setup Style						Dimensions (m)	Area (sqm)	Ceiling (m)
	Reception	Theatre	Banquet	Classroom	Cluster	U-Shape			
Azalea	300	408	220	207	154	117	38.4 x 9.2	353.3	2.3
Azalea I	70	96	50	45	35	33	11.7 x 9.2	107.6	
Azalea II	100	120	90	63	63	39	13.6 x 9.2	125.1	
Azalea III	100	120	90	54	63	33	13.1 x 9.2	120.5	
Azalea I & II	200	264	140	126	98	75	25.3 x 9.2	232.8	
Azalea II & III	220	288	160	135	112	81	26.7 x 9.2	245.6	
Orchid	100	136	80	66	56	51	20.4 x 5.2	106	Low: 2.2 Alcove: 3.7
Orchid I	30	16	20	12	14	9	3.9 x 5.2	20.3	
Orchid II	50	40	30	24	21	15	8.4 x 5.2	43.7	
Orchid III	50	40	30	24	21	15	8.1 x 5.2	42	
Orchid I & II	60	72	50	36	35	27	12.3 x 5.2	64	
Orchid II & III	80	112	60	60	42	39	16.5 x 5.2	85.8	
Hibiscus	200	300	200	150	140	123	41.2 x 5.7	234.8	Low: 2.2 Alcove: 3.7
Hibiscus I	100	104	80	54	56	39	16.4 x 5.7	93.5	
Hibiscus II	60	72	50	36	35	27	12.6 x 5.7	71.8	
Hibiscus III	60	72	50	36	35	27	12.2 x 5.7	69.5	
Hibiscus I & II	150	200	140	102	98	81	29 x 5.7	165.3	
Hibiscus II & III	120	160	110	84	77	69	29 x 5.7	141.4	
Peony	120	144	100	66	70	51	20.8 x 5.8	120.6	Low: 2.2 Alcove: 3.7
Peony I	40	40	30	18	21	9	8.2 x 5.8	47.6	
Peony II	60	72	50	36	35	27	12.6 x 5.7	73	
Lotus	120	168	80	81	56	42	17 x 7.7	131	2.3
Lotus I	60	60	40	27	28	18	8.5 x 7.7	65.5	
Lotus II	60	60	40	27	28	18	8.5 x 7.7	65.5	
Gardenia	80	120	60	54	42	36	12.9 x 7.1	91.6	2.2
Boardroom	-	-	-	-	-	-	10.4 x 5.8	60.3	2.7

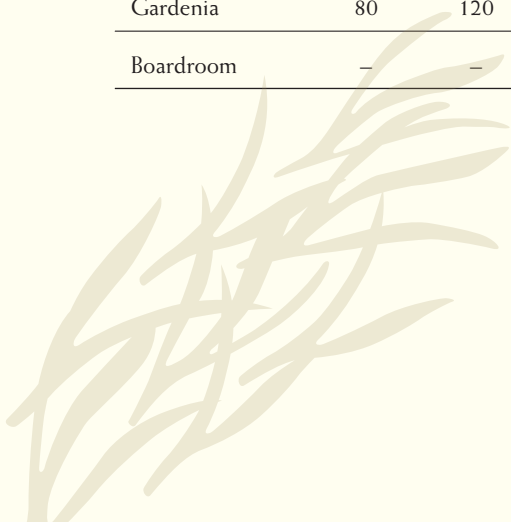

BANQUET AND CONFERENCE ROOMS

Venue	Capacity & Setup Style						Dimensions (m)	Area (sqm)	Ceiling (m)
	Reception	Theatre	Banquet	Classroom	Cluster	U-Shape			
Island Ballroom	1,200	1,400	1,000	960	–	–	26.3 x 51.6	1,357	7.9
Island A	600	700	520	450	–	–	26.3 x 26.8	705	7.9
Island B	500	650	520	450	–	–	26.3 x 24.8	652	7.9
Jurong	300	400	270	242	–	–	26.3 x 15.8	416	7.9
Tanglin	330	450	270	286	–	–	25.3 x 9.2	473	7.9
Katong	330	450	270	264	–	–	26.3 x 17.8	468	7.9
Jurong / Tanglin	600	650	650	570	–	–	26.3 x 33.8	889	7.9
Tanglin / Katong	600	650	650	570	–	–	26.3 x 35.8	942	7.9
Island Foyer	–	–	–	–	–	–	13.8 x 42	580	3.8
Tower Ballroom	680	900	590	648	–	–	24.7 x 37.8	934	5.8
Tower A	350	380	300	312	–	–	24.7 x 18.8	464	5.8
Tower B	350	380	300	336	–	–	24.7 x 19	469	5.8
Casuarina	220	240	160	154	–	–	24.7 x 11.5	284	5.8
Acacia	250	320	220	220	–	–	24.7 x 14.7	363	5.8
Banyan	220	240	160	154	–	–	24.7 x 11.7	289	5.8
Casuarina / Acacia	500	600	380	330	–	–	24.7 x 26.2	647	5.8
Acacia / Banyan	500	600	380	330	–	–	24.7 x 26.4	652	5.8
Tower Foyer	–	–	–	–	–	–	10.4 x 34.1	337	3.6
State Room	60	80	50	36	–	–	11.4 x 8.7	101	3.4
Summit Room	60	–	50	–	–	–	10.0 x 10.0	100	4.5
Garden Terrace	130	120	120	54	–	–	27.0 x 18.0	486	2.75
Dutch Pavilion	120	100	100	70	–	–	31.0 x 9.5	264	4.0
Banyan Deck	160	–	–	–	–	–	–	240	–

For Banquet set-up, all tables used are 5ft round tables.
 For Island Ballroom, a stage of 32' x 16' is catered for.
 For Tower Ballroom, a stage of 24' x 12' is catered for.

RESTAURANTS AND BARS

Restaurants / Bars	Capacity	Location	Cuisine
The Line*	380	Lower lobby level, Tower Wing	International buffet
Shang Palace	156	Lower lobby level, Tower Wing	Cantonese
The Waterfall*	110	Lower lobby level, Garden Wing	Southern Italian
The Rose Veranda	100	Mezzanine level, Tower Wing	High tea and decadent desserts
The Lobby Lounge	144	Lobby level, Tower Wing	Heritage hawker cuisine
Nami	144	Level 24, Tower Wing	Japanese
ShopHouse by Shangri-La	–	Lobby level, Tower Wing	Bakeshop / snacks
Origin Grill & Bar	140	Lobby level, Tower Wing	Grill / cocktails

* indoor and outdoor seating available

ISLAND / TOWER BALLROOM

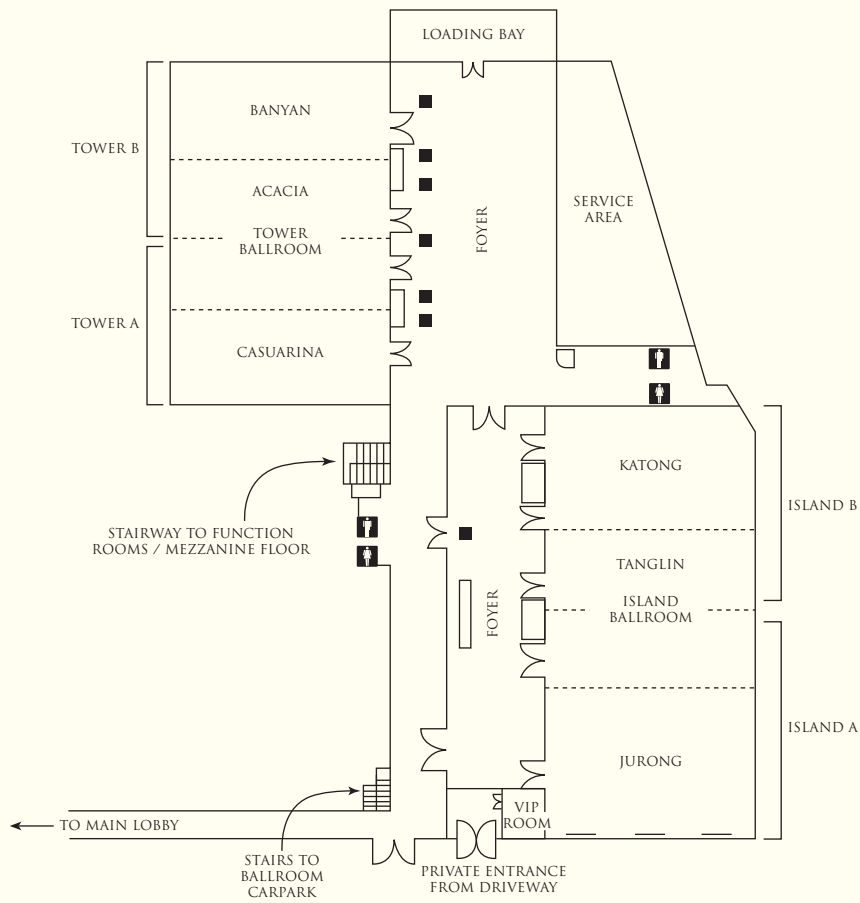

MEZZANINE FLOOR

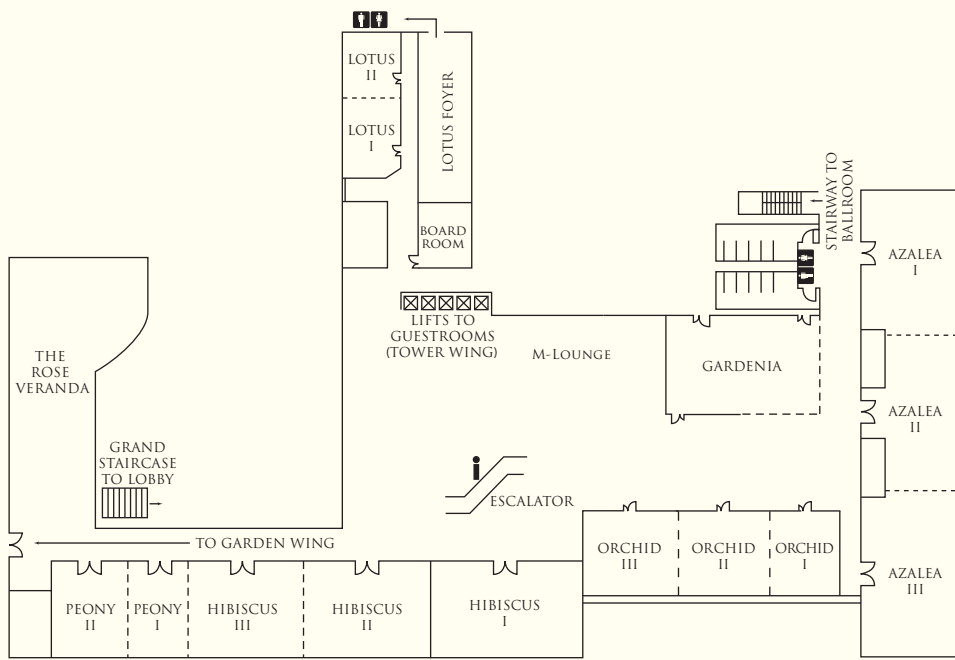

DUTCH PAVILION

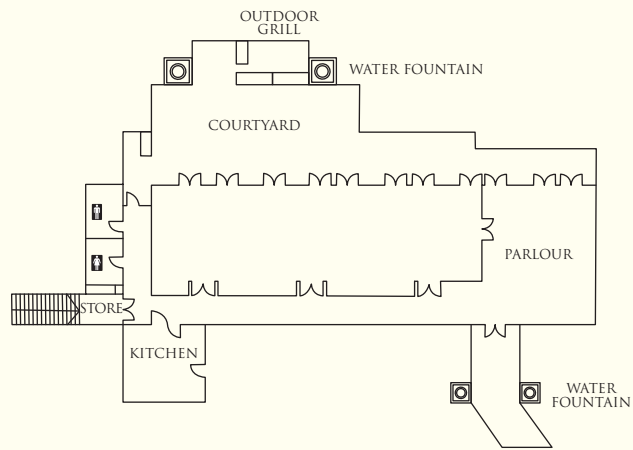

GARDEN TERRACE

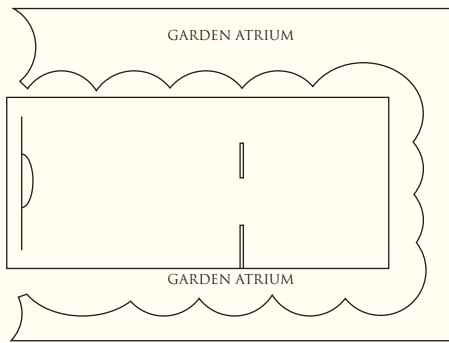

BANYAN DECK

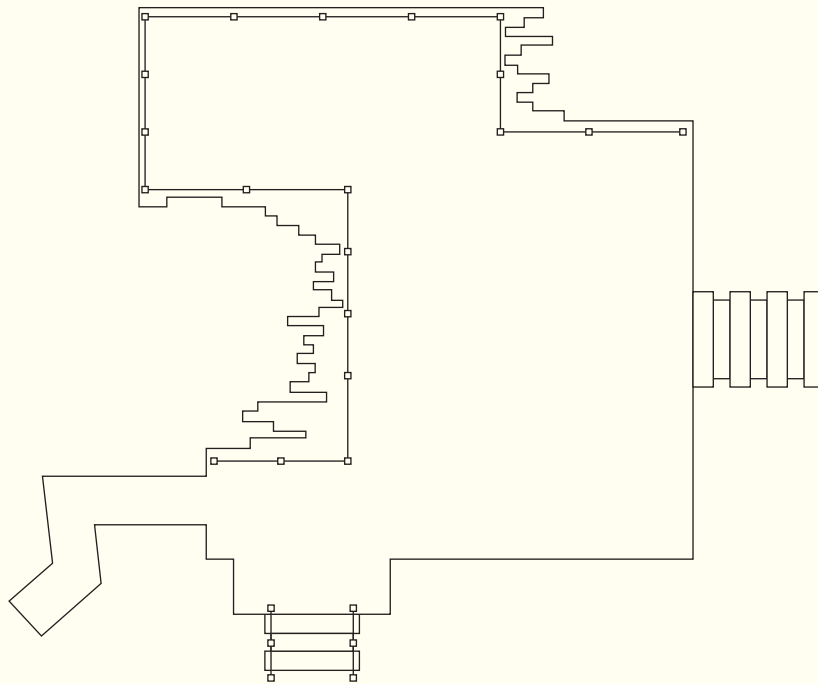



Shangri-La hotel

SINGAPORE

22 Orange Grove Road, Singapore 258350 Tel: (65) 6737 3644
Website: www.shangri-la.com Email: sls@shangri-la.com