



FACTS AND INFORMATION

MAKATI SHANGRI-LA, MANILA

LOCATION

Conveniently located in the heart of Manila's most prestigious business, commercial and shopping district, Makati Shangri-La, Manila is the perfect base for both business and leisure travelers, with the city's top malls and entertainment venues within easy walking distance.

The Ninoy Aquino International Airport Terminal One is approximately 30-40 minutes away (10.8km from the hotel), while Terminals Two and Three are approximately 20-40 minutes away (11km and 6.3km from the hotel, respectively).



ACCOMMODATION

The hotel's 696 luxurious guestrooms and suites are some of the largest in Manila, all featuring plush 300-threadcount bed linen and flat screen LED television. For guests requiring the highest level of personalised attention, there is the prestigious Horizon Club accommodation with exclusive privileges.

GUESTROOMS

Categories	Rooms	Area (m ²)
Superior	358	33 - 42
Deluxe	150	39 - 42
Executive Room	36	53 - 54
Horizon Deluxe	95	33 - 42
Horizon Executive Room	7	53 - 54
Deluxe Suite	46	74
Speciality Suite	3	183
Presidential Suite	1	312

GUESTROOM FEATURES

- Complimentary Wi-Fi and broadband internet access
- IDD telephone and voice mail
- Electronic in-room locker
- 24-hour in-room dining
- Full-size executive writing desk
- Mini bar
- Tea / coffee making facilities
- Iron and ironing board

HORIZON CLUB PRIVILEGES

- Personalised check-in and check-out service
- 24-hour Horizon Club Lounge
- Complimentary breakfast
- Evening cocktails
- Complimentary non-alcoholic beverages throughout the day
- One complimentary suit pressing per day

BUSINESS CENTRE

The business centre offers a wide range of secretarial support, including translation, copying and courier services. A range of private meeting rooms and computer stations are also available, complemented by an extensive selection of the latest audio-visual and communications technologies.

RECREATION FACILITIES

- Fully-equipped health club with 24-hour gym
- Outdoor swimming pool
- Two (2) outdoor floodlit tennis courts
- Sauna and steam room
- Hot and cold jacuzzis
- 24-hour spa and massage facilities

OTHER SERVICES AND FACILITIES

- Airport transfers
- Airport VIP arrival and departure assistance
- Complimentary shoeshine service
- Automated teller machine (ATM)
- Foreign currency exchange counter
- Hair / beauty salon
- Same day laundry and valet service
- Safety deposit box
- Shopping arcade
- Taxi and limousine service
- Travel agency / tour desk

RESTAURANTS AND BARS

Restaurants / Bars	Capacity	Location	Cuisine
Circles Event Café	320*	Lobby level	International all-day dining
Lobby Lounge	143	Lobby level	Local and international snacks
Sinfully Circles	•	Lobby level	Patisserie
Sage Bar	94	Lobby level	Gastropub
Sage Bespoke Grill	88*	Level 2	International Steakhouse
Inagiku	163*	Level 2	Authentic Japanese
Shang Palace	320*	Level 2	Authentic Cantonese
Pool Bar	50	Level 4	Snacks and beverages

* Includes capacity of private dining areas

BANQUET AND CONFERENCE ROOMS

Venue	Capacity				Dimensions (m)	Area (m ²)	Ceiling Height (m)
	Reception	Theatre	Banquet	Classroom			
Lower Lobby							
Isabela Ballroom	420	540	300	230	17.5 x 34.0	603	3.8
Isabela Ballroom A	120	120	80	63	20.0 x 8.5	170	3.8
Isabela Ballroom B	120	120	60	63	17.5 x 8.5	144	3.8
Isabela Ballroom C	180	300	120	105	17.5 x 17.0	289	3.8
Isabela Dining Area	•	•	•	•	14.0 x 8.4	118	3.8
Isabela Foyer	•	•	•	•	•	253	•
Level 1							
Manila Room	120	280	150	114	13.4 x 18.9	253	3.0
Manila Room A	60	120	60	54	13.4 x 8.2	110	3.0
Manila Room B	120	160	90	60	13.4 x 10.6	143	3.0
Makati Room	100	240	120	108	13.4 x 16.4	220	3.0
Makati Room A	60	60	60	54	13.4 x 8.2	110	3.0
Makati Room B	60	60	60	54	13.4 x 8.2	110	3.0
Mandaluyong Room	30	60	40	36	7.7 x 9.4	72	2.5
Level 2							
Rizal Ballroom	1,500	1,540	960	990	35.4 x 41.4	1,466	5.7
Rizal Ballroom A	500	480	320	270	37.0 x 13.7	507	5.7
Rizal Ballroom B	500	480	320	270	30.0 x 14.0	420	5.7
Rizal Ballroom C	500	480	320	270	30.0 x 13.7	411	5.7
Rizal Foyer	•	•	•	•	24.3 x 8.0	194	•
Level 3							
Pasay Room	180	140	120	72	10.3 x 17.6	180	3.0
Pasay Room A	60	72	60	42	10.3 x 8.8	90	3.0
Pasay Room B	60	72	60	42	10.3 x 8.8	90	3.0
Parañaque Room	180	140	120	72	10.3 x 17.6	180	3.0
Parañaque Room A	60	72	60	42	10.3 x 8.8	90	3.0
Parañaque Room B	60	72	60	42	10.3 x 8.8	90	3.0
Pasig A Boardroom	•	•	•	•	8.8 x 7.7	67	3.0
Pasig B Boardroom	•	•	•	•	5.0 x 5.5	28	3.0
Pasig C Boardroom	•	•	•	•	4.1 x 8.2	34	3.0
Patio	160	180	140	•	•	•	•

In compliance with government-mandated guidelines, event room floorplans and seating capacities are temporarily adjusted. (July 2020)

LOWER LEVEL 1

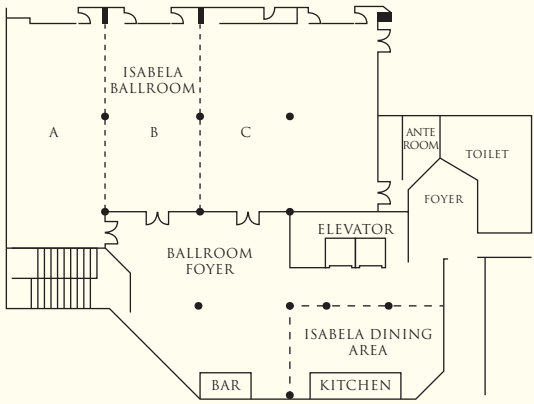

LEVEL 1

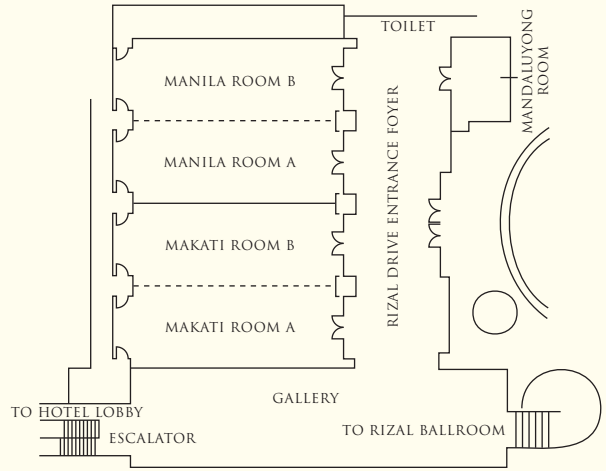

LEVEL 2

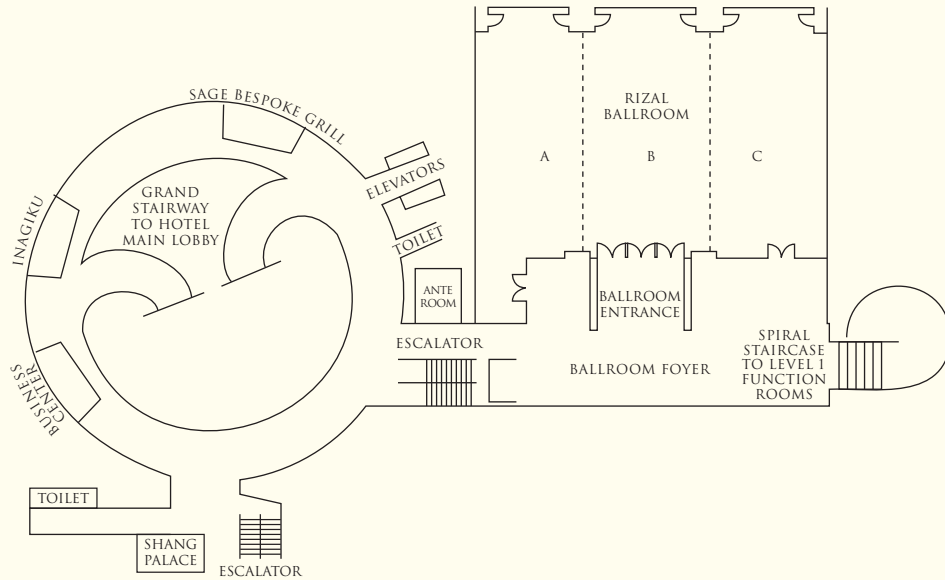

LEVEL 3

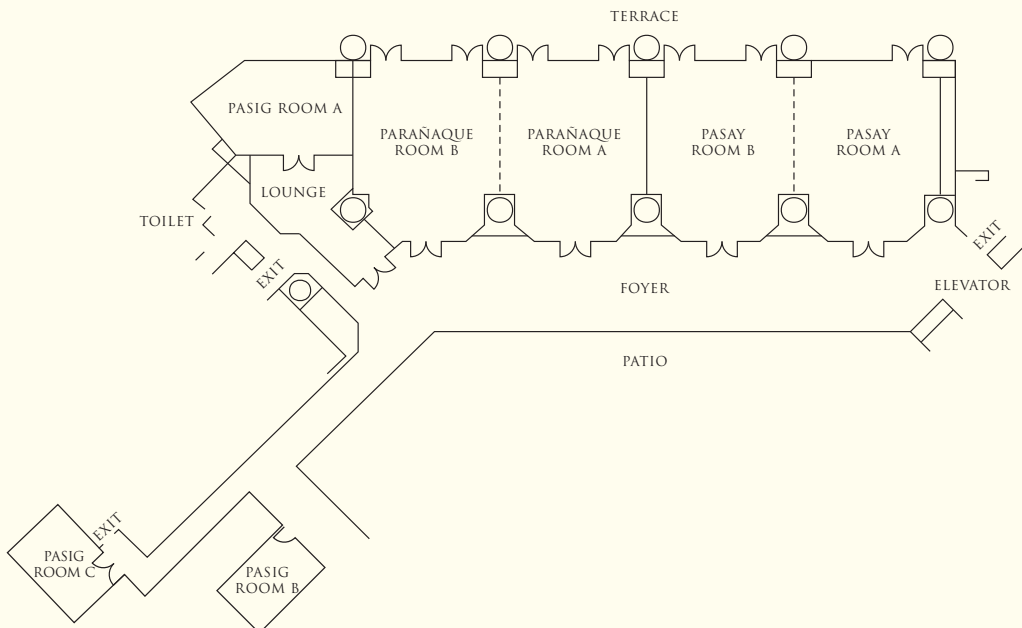



SHANGRI-LA

HOTELS *and* RESORTS

Makati Shangri-La, Manila

Ayala Avenue corner Makati Avenue, Makati City, 1200, Philippines

Tel: (63 2) 8813 8888 Fax: (63 2) 8813 5499 makati@shangri-la.com www.shangri-la.com