



## FACTS AND INFORMATION

SHANGRI-LA HOTEL, WUHAN

## LOCATION

Shangri-La Hotel, Wuhan is conveniently located in the heart of the Hankou business and financial district and is only a short 30-minute drive from Wuhan Tianhe International Airport and a 10-minute drive from Hankou Railway Station.

## ACCOMMODATION

The hotel comprises 442 guestrooms, which include 22 elegantly appointed suites. For longer staying guests, there are 45 fully serviced apartments with a choice of one or two bedrooms. Horizon Club rooms offer an enhanced level of service, comfort and convenience for busy travellers.

## GUESTROOM FEATURES

The luxuriously appointed rooms include:

- LCD / LED television
- International direct dialling telephones with voice mail
- 24-hour room service
- Individually controlled air conditioning
- Mini bar and refrigerator
- Electronic safe
- Tea and coffee making facilities
- Hairdryer
- Data ports
- Broadband Internet access
- Wi-Fi service

## HORIZON CLUB PRIVILEGES

On the Horizon Club floors, the following exclusive benefits and secretarial support are provided:

- VIP check-in service
- Complimentary breakfast
- Complimentary afternoon tea
- Private lounge
- Three meeting rooms
- Printers, scanners, computers, translators, photocopying, facsimile and express



## RECREATIONAL FACILITIES

- Whirlpool
- Sauna
- Steam bath
- Massage facilities
- Indoor swimming pool
- Tennis court
- Gymnasium

## OTHER SERVICES AND FACILITIES

- Courier, parcel and postal services
- Same day laundry and valet service
- Limousine rental service
- Complimentary shoe shine service
- 185-bay underground car park
- Safe deposit boxes

## GUESTROOMS

Categories	King	Twin	Area (m <sup>2</sup> )
Superior Room	60	111	36 - 43
Deluxe Room	114	60	36 - 43
Horizon Club Room	68	5	36 - 43
Handicapped Room	1	1	36 - 43
Executive Suite	19	1	86
Premier Suite	1	•	125
Presidential Suite	1	•	208

## SERVICED APARTMENT

Categories	Number Available	Area (m <sup>2</sup> )
Superior One Bedroom (2 bay)	26	72 - 86
Superior One Bedroom (2 bay corner)	11	72 - 86
Deluxe One Bedroom (3 bay)	4	108
Deluxe Two Bedroom (3 bay)	3	108
Deluxe Two Bedroom (4 bay)	1	160
Total	45	•

## RESTAURANTS AND BARS

Restaurants / Bars	Capacity	Location	Cuisine
Shang Palace	140	Level 2	Chinese
Cafe Wu	144	Level 1	International
Lobby Lounge	94	Level 1	Snacks and drinks
tori-ji	76	Level B1	Yakitori and Teppan
Gourmet Corner	•	Level 1	Pastry

## BANQUET AND CONFERENCE ROOMS

Venue	Capacity						Dimensions (m)	Area (m <sup>2</sup> )	Ceiling Height (m)
	Reception	Theatre	Banquet	Classroom	U-Shape	Boardroom			
<b>Level 2</b>									
Grand Ballroom	1,200	1,200	840	800	•	•	32.0 x 50.0	1,600	7.0
Han Kou	400	400	280	240	90	•	32.0 x 16.6	533	7.0
Wu Chang	400	400	280	240	90	•	32.0 x 16.6	533	7.0
Han Yang	400	400	280	240	90	•	32.0 x 16.6	533	7.0
VIP Room	20	•	20	•	•	10	8.0 x 6.0	48	3.1
Huang Shi VIP Room	18	•	•	•	•	•	6.4 x 12.2	78	2.7
Pre-Function Area	500	•	•	•	•	•	22.0 x 30.0	660	3.1
<b>Level 3</b>									
Xian Tao	100	80	40	50	42	42	16.5 x 7.3	110	3.0 / 2.7
Sui Zhou	40	48	10	24	15	18	9.6 x 5.7	55	3.0 / 2.7
En Shi	100	100	40	54	39	42	18.0 x 6.9	125	3.8 / 3.4
Xiang Yang	120	120	80	72	42	48	18.0 x 11.6	208	3.8 / 3.4
<b>Level B1</b>									
Shi Yan	90	90	50	48	33	36	11.4 x 9.5	108	2.7
Jing Men	80	80	40	50	33	36	10.6 x 8.3	88	2.7
Xiao Gan	50	50	30	27	21	24	8.4 x 8.1	68	2.7

LEVEL 2 GRAND BALLROOM

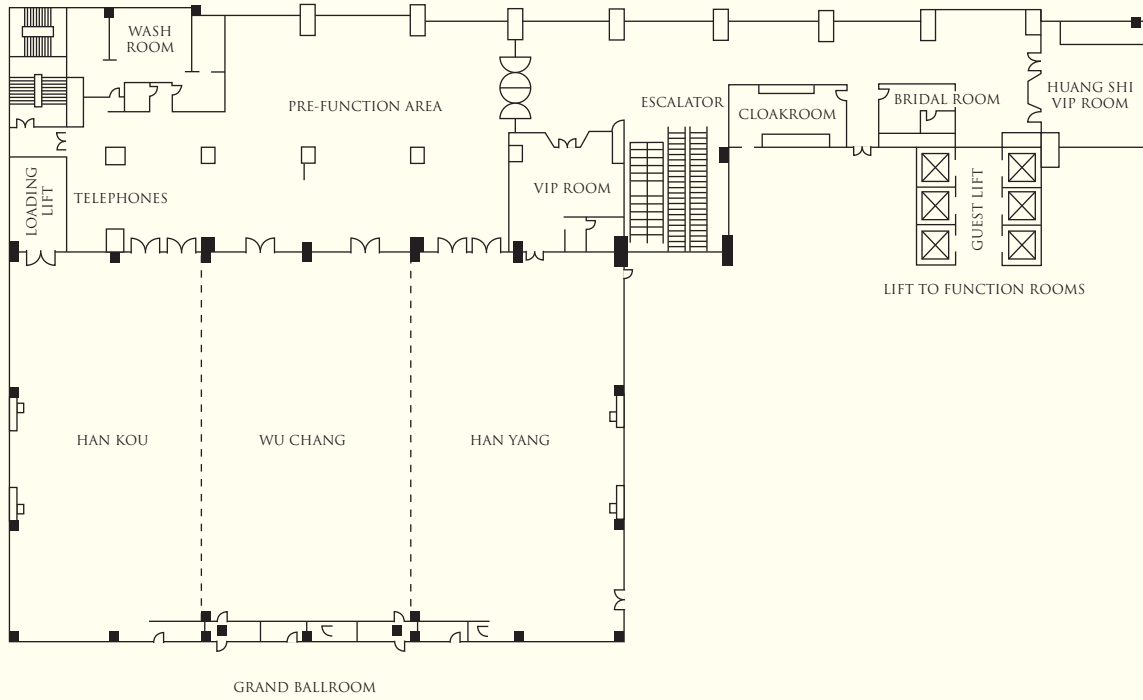

LEVEL 3 FUNCTION ROOMS

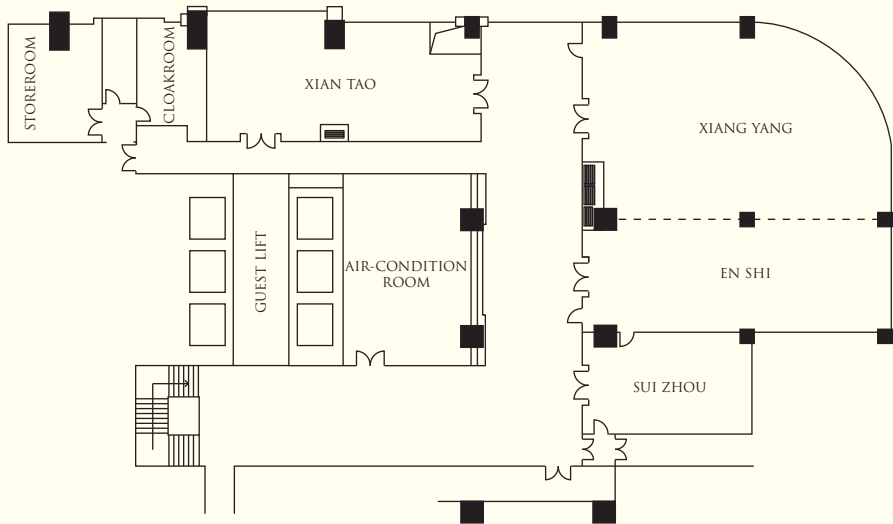

LEVEL B1 FUNCTION ROOMS

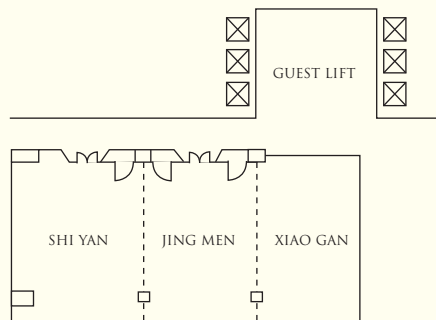



**SHANGRI-LA**

HOTELS *and* RESORTS

Shangri-La Hotel, Wuhan

700 Jian She Avenue, Hankou, Wuhan 430015, China

Tel: (86 27) 8580 6868 Fax: (86 27) 8577 6868 [slwu@shangri-la.com](mailto:slwu@shangri-la.com) [www.shangri-la.com](http://www.shangri-la.com)