



## FACTS AND INFORMATION

SHANGRI-LA HOTEL, MANZHOU LI

## LOCATION

Shangri-La Hotel, Manzhouli is conveniently situated east of Tong He Road and north of Liudao street in the heart of the city centre, and a mere 20-minute drive from the airport and 5-minutes from the train station. With the China-Russia border crossing nearby, Manzhouli is China's busiest inland port of entry yet features many attractions including Xiao Bei Lake, Matryoshka Square and the Russian Art Museum.

## ACCOMMODATION

The hotel features 235 luxurious rooms including 24 Suites with views of the city or the renowned Xiao Bei Lake.

## GUESTROOMS

| Categories       | Rooms | Average Area (m <sup>2</sup> ) |
|------------------|-------|--------------------------------|
| Superior Room    | 79    | 38                             |
| Deluxe Room      | 78    | 38                             |
| Premier Room     | 22    | 42                             |
| Horizon Room     | 32    | 38                             |
| Executive Suite  | 15    | 76                             |
| Horizon Suite    | 6     | 76                             |
| Chancellor Suite | 1     | 114                            |
| Chairman Suite   | 1     | 114                            |
| Shangri-La Suite | 1     | 198                            |

## GUESTROOM FEATURES

- 24-hour room service
- Electronic in-room locker
- Broadband Internet access
- Satellite / cable television
- Data port / IDD / Voice Mail
- Executive desk with built-in multi-plug socket
- Coffee and Tea making facilities
- Fully stocked mini bar
- Same day laundry and valet service
- Facilities for the physically challenged

## BUSINESS CENTRE

Fully-equipped business centre is designed to provide the business and secretariat support that frequent travellers require, including translation, printing, photocopying, scanning, facsimile, broadband internet access and courier services.

## RECREATION FACILITIES

Health Club with:

- Fitness Centre
- Indoor swimming pool
- Steam bath
- Sauna

## OTHER SERVICES AND FACILITIES

- Airport transfer & Limousine Service
- Underground car park and valet service
- 24 hours concierge service
- Shoeshine service
- Tour desk
- Babysitter service upon request

## BANQUET AND CONFERENCE FACILITIES

| Venue  | Capacity  |         |         |           | Dimensions<br>(m) | Area<br>(sqm) | Ceiling Height<br>(m) |
|--|-----------|---------|---------|-----------|-------------------|---------------|-----------------------|
|  | Reception | Theatre | Banquet | Classroom |                   |               |                       |
| Grand Ballroom<br>(Grand Ballroom A, B & C)            | 1800      | 1500    | 1200    | 900       | 90 x 17           | 1,500         | 7.5                   |
| Grand Ballroom A                                       | 600       | 500     | 360     | 300       | 30 x 17           | 500           | 7.5                   |
| Grand Ballroom B                                       | 600       | 500     | 360     | 300       | 30 x 17           | 500           | 7.5                   |
| Grand Ballroom C                                       | 600       | 500     | 360     | 300       | 30 x 17           | 500           | 7.5                   |
| Grand Ballroom Foyer                                   | 600       | •       | •       | •         | 37 x 10           | 376           | 4.0                   |
| Manzhouli  | 120       | 100     | 72      | 100       | 12 x 15           | 173           | 3.8                   |
| Heilongjiang Ballroom<br>(Jilin, Heilongjiang & Hebei) | 400       | 380     | 216     | 200       | 34 x 11           | 374           | 3.8                   |
| Jilin  | 120       | 100     | 84      | 60        | 11 x 11           | 105           | 3.8                   |
| Heilongjiang   | 150       | 120     | 96      | 70        | 12 x 11           | 132           | 3.8                   |
| Hebei  | 120       | 100     | 84      | 60        | 11 x 11           | 105           | 3.8                   |
| Gansu  | 200       | 170     | 168     | 90        | 12 x 14           | 168           | 3.8                   |

## RESTAURANTS AND BARS

| Restaurant / Bar | Capacity | Location     | Cuisine                             |
|------------------|----------|--------------|-------------------------------------|
| Lobby Lounge     | 80       | Ground Floor | Light refreshments<br>Afternoon tea |
| Café 99          | 118      | Ground Floor | Buffet Breakfast<br>All day dining  |
| Shang Palace     | 250      | 2nd Floor    | Cantonese / Northern Chinese        |
| Salt and Bread   | 258      | Ground floor | Russian                             |

LEVEL 2

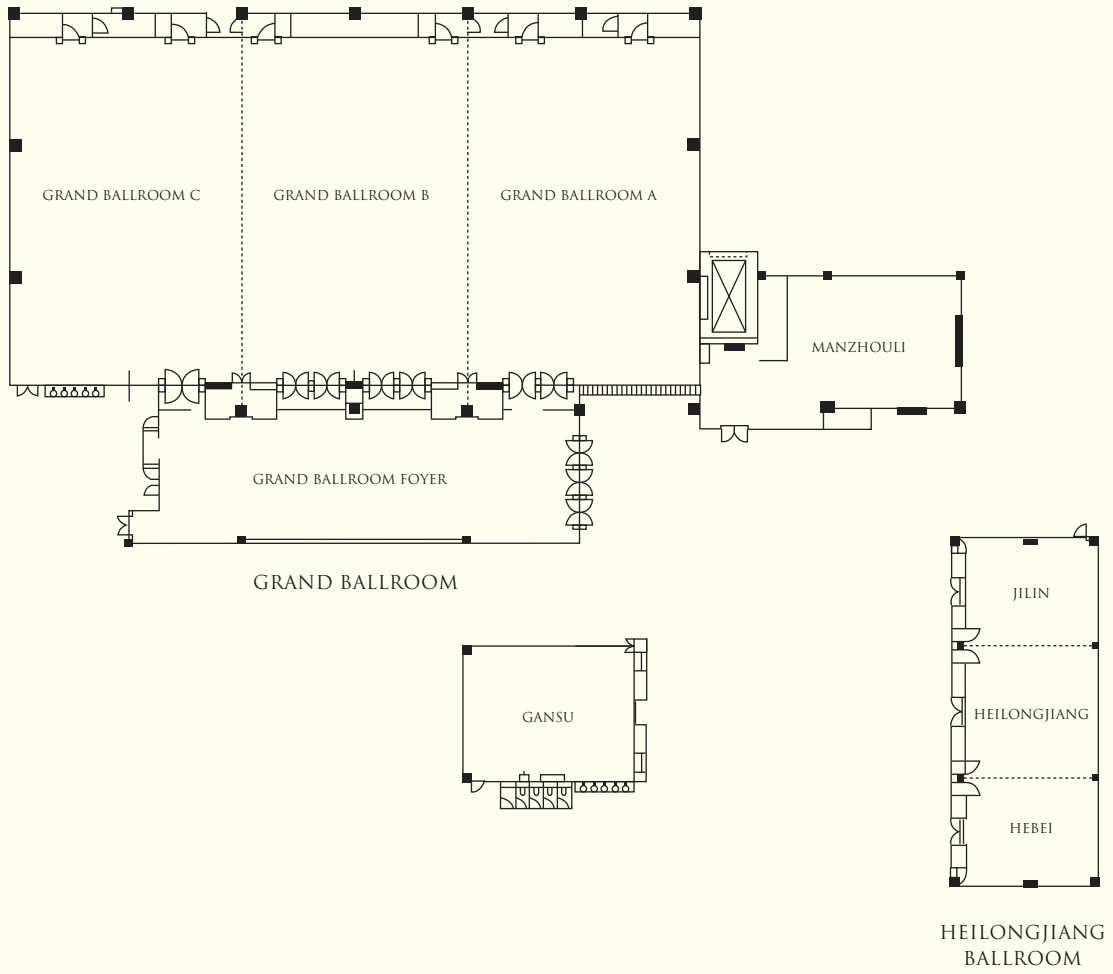



**SHANGRI-LA**

HOTELS *and* RESORTS

**Shangri-La Hotel, Manzhouli**

99 Liudao Street, Manzhouli 021400, Inner Mongolia, China

Tel (86) 470 3968 888 [www.shangri-la.com](http://www.shangri-la.com)