



## FACTS AND INFORMATION

SHANGRI-LA'S TANJUNG ARU RESORT & SPA  
KOTA KINABALU

## LOCATION

Just two and a half hours by air from Singapore and Hong Kong, located within easy access of five idyllic islands, and set amidst 25 acres of landscaped gardens overlooking a sweeping bay, Shangri-La's Tanjung Aru Resort & Spa is a piece of heaven. It's also just ten minutes from the city centre and the Kota Kinabalu International Airport.



## ACCOMMODATION

The resort consists of 492 guestrooms and suites, all with private balconies.

### GUESTROOMS

Categories	Rooms	Area (m <sup>2</sup> )
<b>Tanjung Wing</b>		
Seaview Room	218	47
Executive Suite	22	108
Deluxe Suite	10	185
Presidential Suite	1	239
<b>Kinabalu Wing</b>		
Mountain View Room	69	45
Seaview Room	89	45
Executive Suite	14	66
Deluxe Suite	5	123
<b>Kinabalu Club</b>		
Mountain View Room	28	45
Seaview Room	36	45

### GUESTROOM FEATURES

- 24-hour room service
- Bathrobe, slippers and hairdryer
- Complimentary broadband and Wi-Fi Internet access
- International direct-dialing dual telephone lines with bathroom extension
- Tea / coffee-making facilities
- Television with 24-hour cable news, satellite, free in-house movie channels and radio with bathroom speaker
- Iron and ironing board in all rooms

### CHI, THE SPA AT SHANGRI-LA

Located on its own private island within the resort's premises, consists of eight island villas, each villa comes with the CHI signature "spa within a spa" concept, featuring private treatment rooms, lounging areas, steam rooms, outdoor gardens and bathing facilities. CHI also features a yoga pavilion with full views of the South China Sea.

### STAR MARINA

Owned and operated by the resort, STAR Marina offers outdoor enthusiasts a choice of motorised and non-motorised water activities, speed boat transfers to the exotic sights of the neighbouring islands, diving courses, chartered fishing trips, sunset cruises as well as an open-air venue for intimate dinners for two or evening functions for up to 100 people.

## RECREATION FACILITIES

- Water Play Area with theme park quality water slides for adults and children
- 2,000-square-metre swimming pool with tapered shoreline, infinity section and jacuzzi beds
- Water Wars water balloon station
- Nine-hole pitch and putt golf course
- Jogging track
- Two tennis courts
- Free entry to Cool Zone kids club
- Kiddies pool
- Sandy beach
- State-of-the-art health club, with gymnasium
- STAR Marina, offering watersport activities, diving, fishing and island transfers

## KINABALU CLUB PRIVILEGES

The Kinabalu Club Lounge on the sixth level of the Kinabalu Wing, offers the following exclusive benefits:

- Complimentary breakfast
- Complimentary evening drinks
- Private lounge
- VIP check-in service

## OTHER SERVICES AND FACILITIES

- 24-hour security
- Baby cots
- Babysitting facilities
- Express check-out
- Foreign exchange
- Hotel shop
- Laundry and valet service
- Shuttle service to Shangri-La's Rasa Ria Resort & Spa
- Tour and travel desks
- Tropical landscaped gardens
- Complimentary Wi-Fi Internet Access

## RESTAURANTS AND BARS

Restaurants / Bars	Capacity	Location	Cuisine
Café TATU	458	Garden level	Western and Asian
Peppino	90	Lobby level	Italian
Coco-Joe's Bar	20	Pool	Beverage
Coco-Joe's Grill	100	Pool	BBQ, Western and Asian
Coco-Joe's Cabanas	80	Sunset beach	BBQ, Western and Asian
Borneo Lounge & Bar	80	Lobby level	Light snacks
Sunset Bar	110	Sunset beach	Light snacks
Cool Box Ice Cream Bar	16	Pool	Dessert
Shang Palace	90	Garden level	Chinese

## BANQUET AND CONFERENCE ROOMS

Venue	Reception	Theatre	Capacity			U-Shape	Dimensions (m)	Area (m <sup>2</sup> )	Ceiling Height (m)
			Banquet	Classroom					
<b>Level 1</b>									
Grand Ballroom	1,200	1,000	640	400	160	31.8 x 21.0	668	7.0	
Ballroom Foyer	200	150	150	100	•	31.9 x 6.9	219	5.4	
Ballroom 1	250	200	210	130	60	10.5 x 21.0	220	7.0	
Ballroom 2	250	200	210	130	60	10.2 x 21.0	214	7.0	
Ballroom 3	250	200	210	130	60	10.5 x 21.0	220	7.0	
The Pavilion	180	150	140	80	40	•	361	3.3(side)/5.9(centre)	
Hibiscus Room	120	100	130	30	21	15.8 x 9.2	145	2.7	
Hibiscus Foyer	30	50	50	•	•	9.45 x 7.0	66	2.4	
<b>Level 2</b>									
Tanjung Room	300	250	240	150	80	21.3 x 12.6	268	4.0	
Tanjung Room Foyer	170	150	80	•	•	24.0 x 4.5	108	4.0	
Tanjung Room 1	100	60	80	45	30	6.9 x 12.6	87	4.0	
Tanjung Room 2	100	60	80	45	30	6.9 x 12.6	87	4.0	
Tanjung Room 3	100	60	80	45	30	6.9 x 12.6	87	4.0	
Boardroom A	•	•	10	•	8	6.0 x 5.0	30	2.4	
Boardroom B	•	•	10	•	8	6.0 x 5.0	30	2.4	
<b>Level 3</b>									
Kinabalu Room	300	250	240	150	80	21.3 x 12.6	268	4.0	
Kinabalu Room Foyer	170	150	80	•	•	24.0 x 4.5	108	4.0	
Kinabalu Room 1	100	60	80	45	30	6.9 x 12.6	87	4.0	
Kinabalu Room 2	100	60	80	45	30	6.9 x 12.6	87	4.0	
Kinabalu Room 3	100	60	80	45	30	6.9 x 12.6	87	4.0	

LEVEL 1

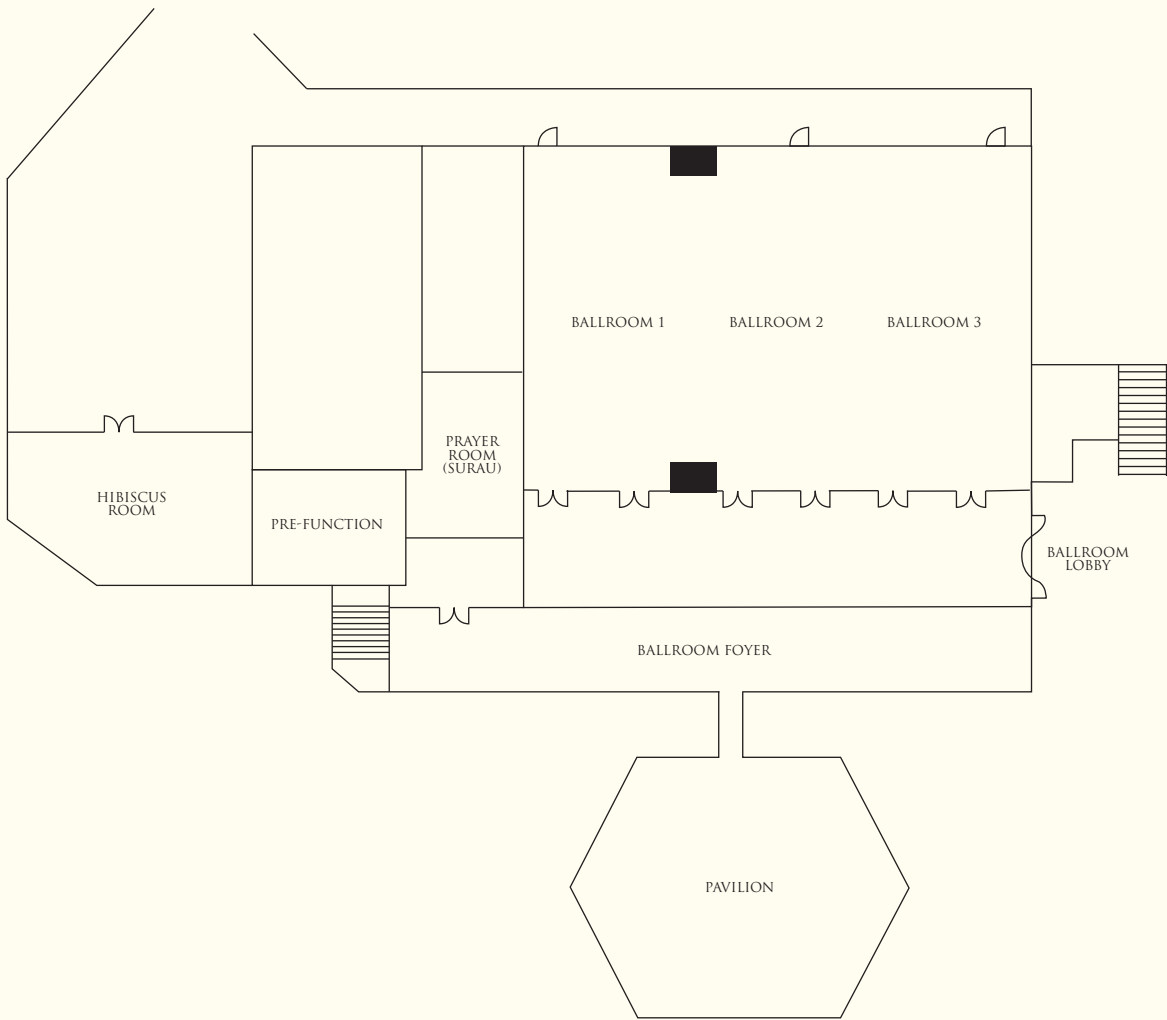

LEVEL 2

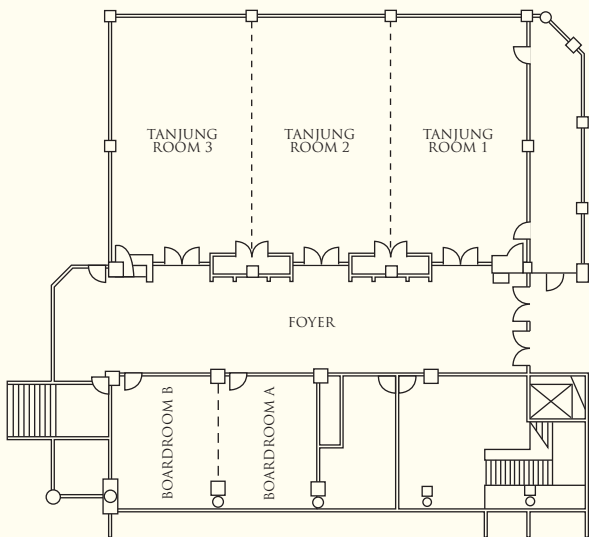

LEVEL 3

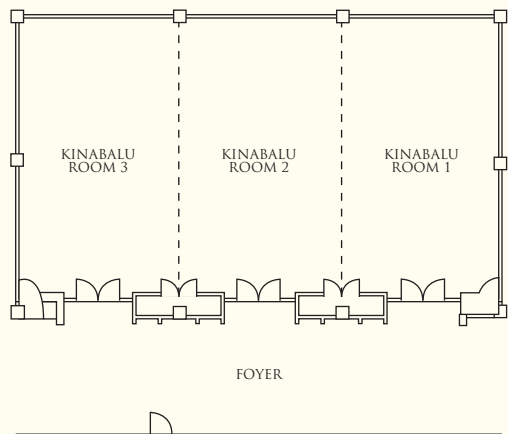



**SHANGRI-LA**

HOTELS *and* RESORTS

Shangri-La's Tanjung Aru Resort & Spa, Kota Kinabalu  
No. 20 Jalan Aru, Tanjung Aru, 88100 Kota Kinabalu, Sabah, Malaysia  
Tel: (60 88) 327 888 Fax: (60 88) 327 878 tah@shangri-la.com www.shangri-la.com