



FACTS AND INFORMATION

SHANGRI-LA'S MACTAN RESORT & SPA
CEBU

LOCATION

Shangri-La's Mactan Resort and Spa, Cebu is set amidst 13 hectares of lush tropical greenery in Lapu-Lapu City, and connected to the main island of Cebu by several bridges. An ideal base for both leisure and business travellers, the resort is only a short 20-minute drive to the Mactan Cebu International Airport.

ACCOMMODATION

The resort comprises 530 lavish guestrooms and suites characterised by contemporary décor with Filipino touches of banana leaf and rattan. Rooms feature memorable views of the Mactan Sea and the surrounding Shangri-La Marine Sanctuary and islets. Ocean Club Rooms, located in the exclusive Ocean Wing, offer an enhanced level of comfort, and provide private balconies facing the beautiful Mactan Channel.



GUESTROOMS

| Categories | Rooms | Area (m ²) |
|--------------------|-------|------------------------|
| Main Wing | | |
| Deluxe | 185 | 34 - 36 |
| Deluxe Sea View | 151 | 34 - 36 |
| Deluxe Family Room | 8 | 54 - 58 |
| Mactan Suite | 3 | 68 |
| Veranda Suite | 5 | 105 |
| Shangri-La Suite | 2 | 136 |
| Ocean Wing | | |
| Premier Room | 80 | 34 - 36 |
| Panorama Room | 20 | 36 |
| Ocean Club Room | 60 | 36 |
| Panorama Suite | 15 | 72 |
| Presidential Suite | 1 | 216 |

GUESTROOM FEATURES

All guestrooms are fully equipped with modern amenities including:

- Complimentary in-room wired Internet and Wi-Fi access
- Cable television
- IDD telephone with bathroom extension
- Laundry and valet service
- Mini-bar
- Voice mail
- Electronic safe
- Coffee and tea-making facilities

BUSINESS CENTRE

The fully equipped business centre offers a wide range of secretarial support including courier, facsimile, photocopying and printing services. Private meeting rooms are also available with a host of modern audiovisual, videoconferencing and projection facilities plus complimentary broadband Internet access and Wi-Fi connection.

CHI, THE SPA AT SHANGRI-LA

A secluded village within the resort, CHI, The Spa at Shangri-La is a luxurious escape of harmony. The spa village sprawls on 10,000 sqm of private villas, gardens, pools and baths - one of the largest of its kind in Asia. Many of the spa's massages and treatments are based on the traditional healing methods found in the Philippines and use natural plants, herbs and botanical products shared by many Asian cultures.

RECREATION FACILITIES

- Adventure Zone is an indoor, air-conditioned playground specially designed for children aged four years and above. The multi-storey playground lets children swing on ropes, climb up and down nets and ladders or crawl through shapes and heights of safely padded vinyl. Daily children's activities are available. Long-sleeved shirts and socks are required for safety.
- The Toddler Zone is a play area for children aged three years and below. Children must be accompanied by a parent or guardian at all times.
- E-Zone is a complete entertainment hub which offers a TimeZone arcade, Xbox 360 video games, wired Internet and Wi-Fi access, a sports lounge, a snack bar and a stylish karaoke room with over 20,000 multilingual songs.
- 350-metre beach cove
- Fully-equipped health club and gym with sauna, steam bath and massage rooms
- (1) 700m² and (1) 1,500m² swimming pool and sundeck areas with separate children's pool and aquaplay area
- Parasailing, sailboats, sea kayaking and windsurfing
- Scuba diving and snorkeling
- Water sports and jet-skiing
- Speedboat fun rides
- Six-hole pitch and putt and themed mini-golf
- Tennis court
- Marine Sanctuary - six-hectare sanctuary that houses over 160 species of marine life

RESTAURANTS AND BARS

| Restaurants / Bars | Capacity | Location | Cuisine |
|-----------------------------------|----------|--------------|-------------------|
| Tides | 303 | Garden level | International |
| Tea of Spring | 117 | Garden level | Chinese |
| Cowrie Cove Seafood Bar and Grill | 220 | Ocean front | Seafood |
| Acqua | 151 | Garden level | Italian |
| Buko Bar | 165 | Pool side | Light fare |
| Lobby Lounge | 145 | Lobby level | Drinks and snacks |
| Breeze | 44 | Beach | Drinks and snacks |

BANQUET AND CONFERENCE ROOMS

| Venue | Capacity | | | | Dimensions (m) | Area (m ²) | Ceiling Height (m) |
|-----------------------|-----------|---------|---------|-----------|-------------------|---------------------------|-----------------------|
| | Reception | Theatre | Banquet | Classroom | | | |
| The Marquee | 1,000 | 900 | 600 | 400 | 34.0 x 34.0 | 1,156 | 11.5 |
| Ocean Pavilion | 100 | 100 | 60 | 30 | 10.0 x 13.8 | 138 | 11.0 |
| Mactan Ballroom | 600 | 600 | 480 | 260 | 48.0 x 14.0 | 672 | 3.6 |
| Pre-function Area | 400 | • | • | • | 48.0 x 10.0 | 480 | 3.6 |
| Mactan Ballroom I | 100 | 100 | 80 | 48 | 8.0 x 14.0 | 112 | 3.6 |
| Mactan Ballroom II | 100 | 100 | 80 | 48 | 8.0 x 14.0 | 112 | 3.6 |
| Mactan Ballroom III | 200 | 200 | 160 | 90 | 16.0 x 14.0 | 224 | 3.6 |
| Mactan Ballroom IV | 200 | 200 | 160 | 90 | 16.0 x 14.0 | 224 | 3.6 |
| Rosal Ballroom | 270 | 240 | 180 | 108 | 24.0 x 13.5 | 324 | 3.7 |
| Rosal Ballroom I | 90 | 80 | 60 | 36 | 8.0 x 13.5 | 108 | 3.7 |
| Rosal Ballroom II | 90 | 80 | 60 | 36 | 8.0 x 13.5 | 108 | 3.7 |
| Rosal Ballroom III | 90 | 80 | 60 | 36 | 8.0 x 13.5 | 108 | 3.7 |
| Function Rooms | | | | | | | |
| Bougainvillea | 35 | 30 | 20 | 15 | 7.9 x 5.4 | 43 | 3.4 |
| Camia | 55 | 30 | 40 | 24 | 7.8 x 7.6 | 59 | 3.4 |
| Jasmine | 110 | 92 | 60 | 55 | 16.4 x 7.6 | 125 | 3.4 |

MAIN WING – GARDEN LEVEL

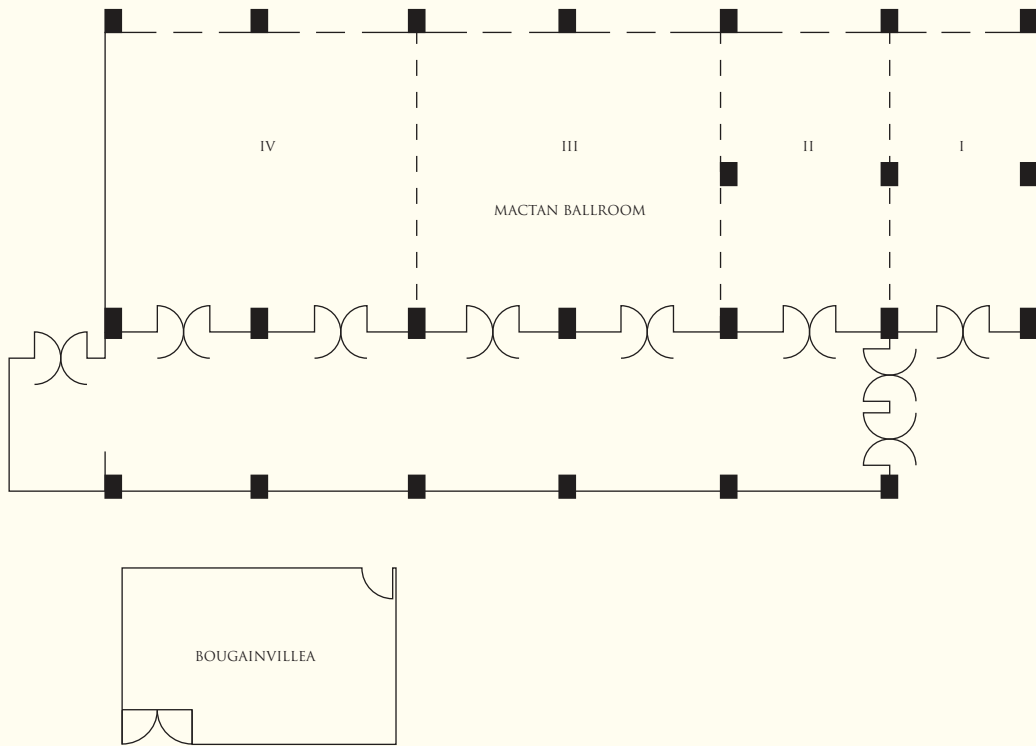

MAIN WING – LOBBY LEVEL

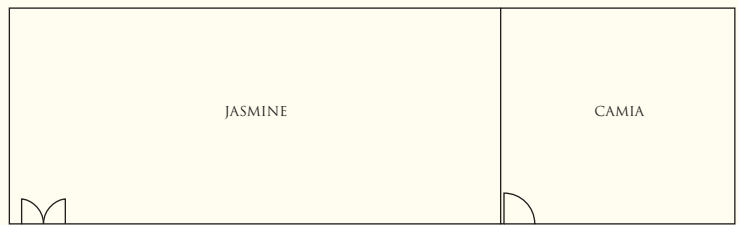

GARDEN LEVEL



GARDEN LEVEL

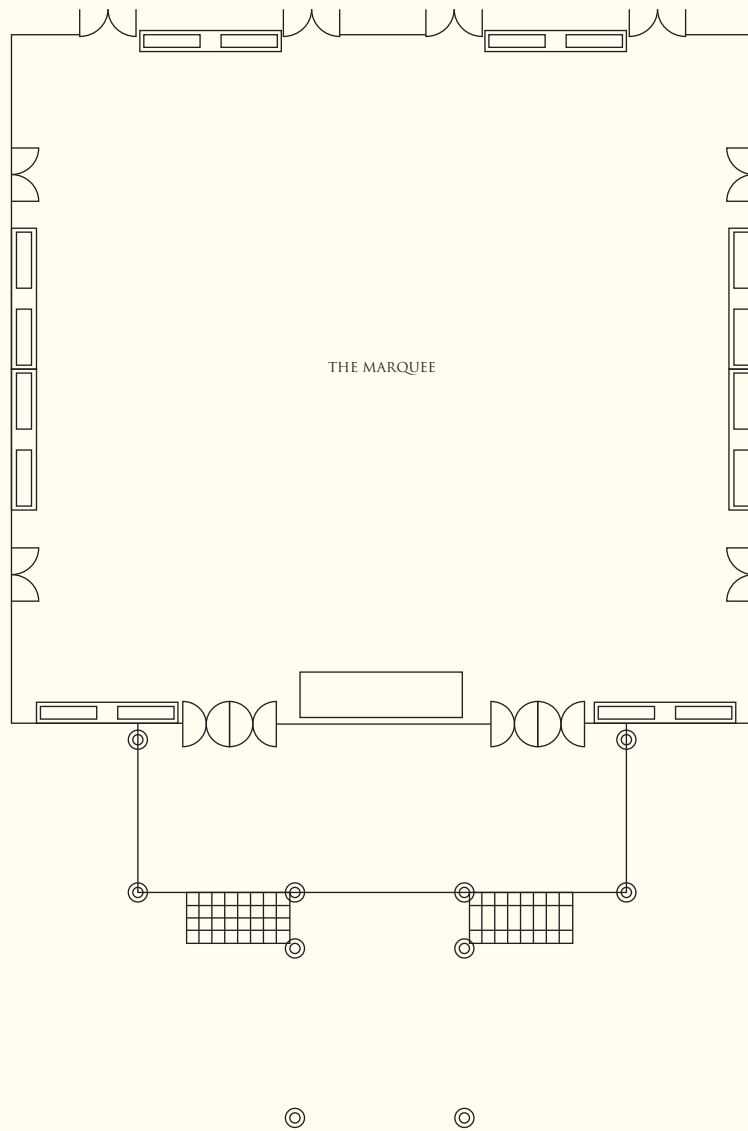

OCEAN WING – GROUND LEVEL

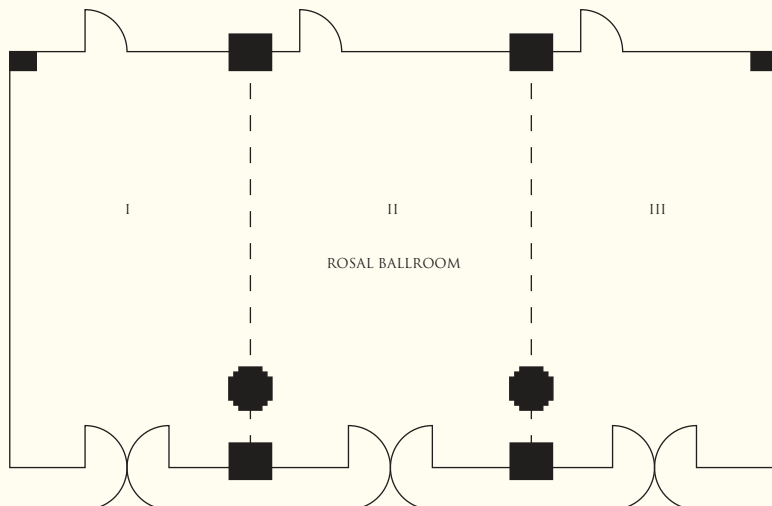



SHANGRI-LA

HOTELS *and* RESORTS

Shangri-La's Mactan Resort & Spa, Cebu

Punta Engaño Road, Lapu-Lapu City 6015, Cebu, Philippines

Tel: (63 32) 231 0288 Fax: (63 32) 231 1688 mac@shangri-la.com www.shangri-la.com